



## **BRESEIGHT AUSTRALIA PTY.LTD.**

**PRECISION ENGINEERS**

45 LANCASTER STR. INGLEBURN 2565 AUSTRALIA

A.B.N. 33 064 251 538

ISO 9001:2015 CERTIFICATE No: QEC11655 – SAI GLOBAL

## **EXCHANGE SUPERSTRUCTURE CATALOGUE**

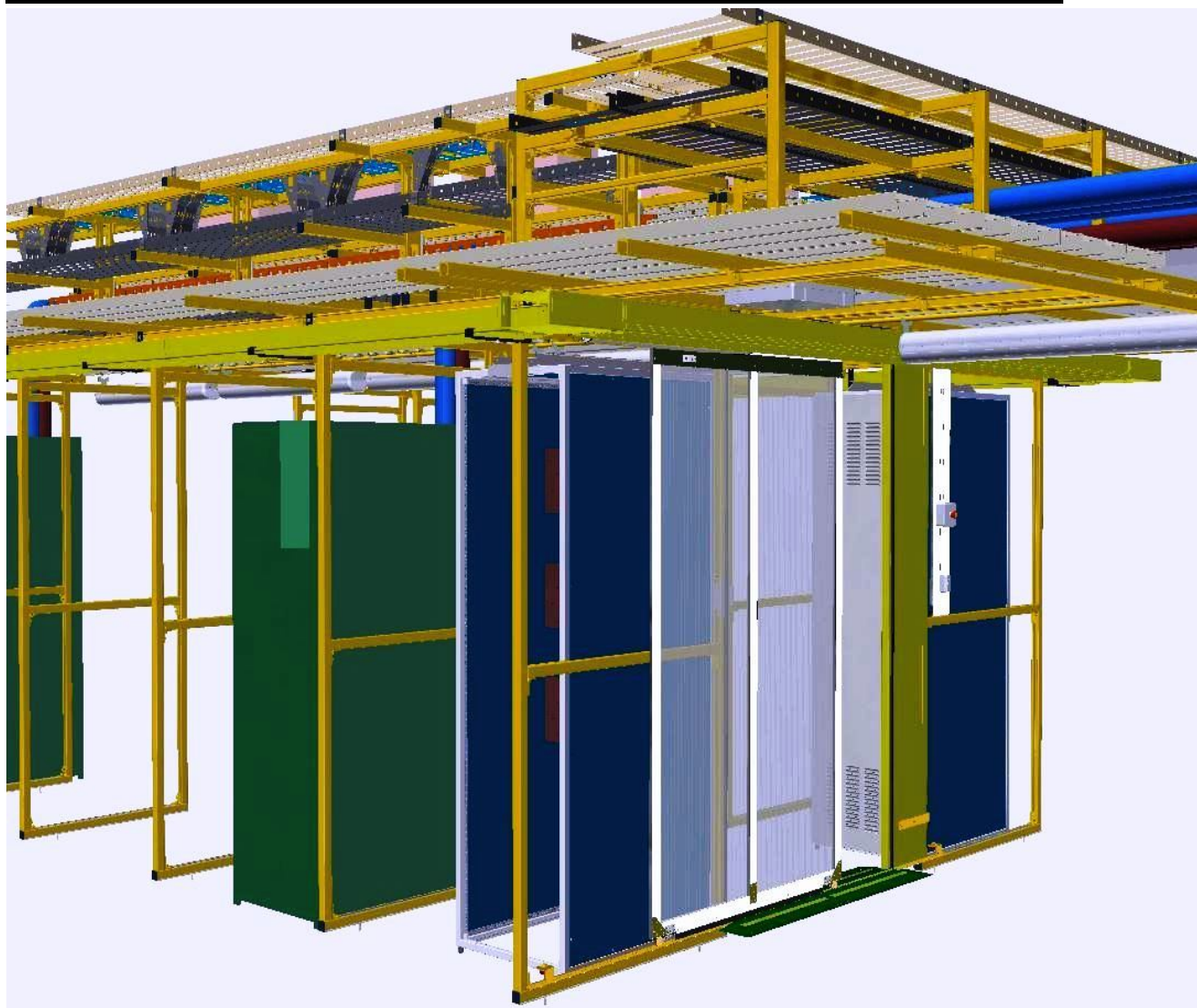

PRINTED: **04/03/2019**  
REVISION 23





# EXCHANGE SUPERSTRUCTURE MODULES

	<b>BRESEIGHT PART #</b> <b>- NAME</b> Description <b>Module #</b>
	<b>B15910-M_1220</b>  <b>- AUTOMATED SLIDING DOOR FOR 1220 OPENING</b>  <i>Aluminium-Polycarbonate light weight sliding door for 1220 opening. Ready to install parts and automation kit.</i>  <b>4000 8772</b>
	<b>B15910-M_1520</b>  <b>- AUTOMATED SLIDING DOOR FOR 1520 OPENING</b>  <i>Aluminium-Polycarbonate light weight sliding door for 1520 opening. Ready to install parts and automation kit.</i>  <b>4000 9311</b>
	<b>B15910-25</b>  <b>- 5 sections safety wedge</b>  <i>For installation at the door entry to avoid 'tripping' hazard.</i>



**B16227**  
**- KIT, INTRASUITE PIPE T-POD**  
**2420-17**

*Parts to build 'walk-on' and pipe supports.  
 Frame-Pipe hurdle and panel intra-suite T-POD for  
 2420mm CTRS installations.*

**4000 9355**



**B16230**  
**- KIT, INTRASUITE PIPE T-POD**  
**2720-17**

*Parts to build 'walk-on' and pipe supports.  
 Frame-Pipe hurdle and panel intra-suite T-POD for  
 2720mm CTRS installations.*

**4000 9356**



**B16229**  
**- KIT, INTERSUITE CABLE**  
**T-POD CN1234**

*Parts to build cable trays support of inter-suite T-POD  
 CN1234.  
 3 frames and 2 450 cable trays and necessary parts.*

**4000 9358**

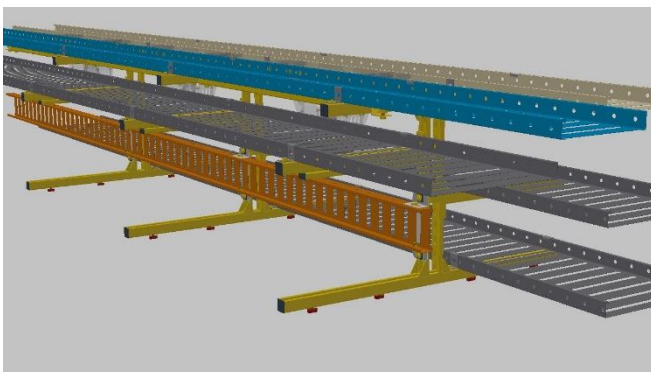

**B16228**  
**- KIT, INTRASUITE PIPE T-POD**  
**CN1234**

*Parts to build cable trays support of intra-suite T-POD  
 CN1234.  
 3 frames, required cable trays and necessary parts.*

**4000 9357**

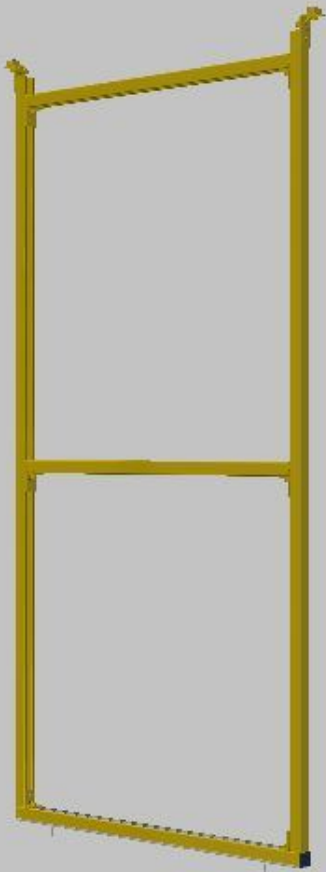
**B9766****- FRAME SUITE SUPPORT 1200 x 2400M**

*1200mm wide Support Frame for T-POD installations can be use in rows with B15869 Support Frames.*

**4000 8766**

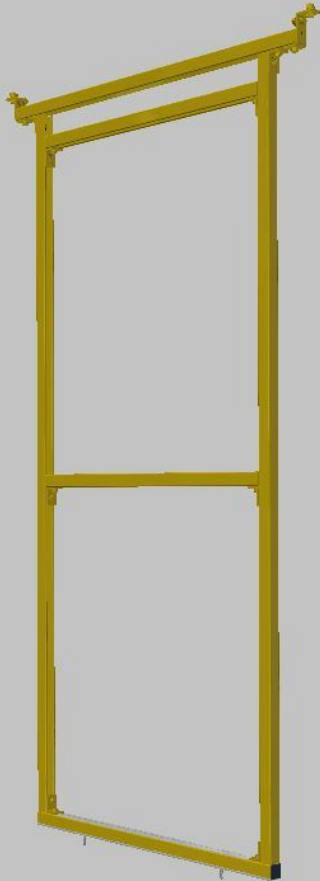
**B15859****- FRAME, POD SUITE SUPPORT 1200 mm x 2.4M**

*1000mm wide Support Frame for T-POD installations – top bar spacing 1200mm. Use in rows with 1200mm 'H' support frames.*

**4000 8767**

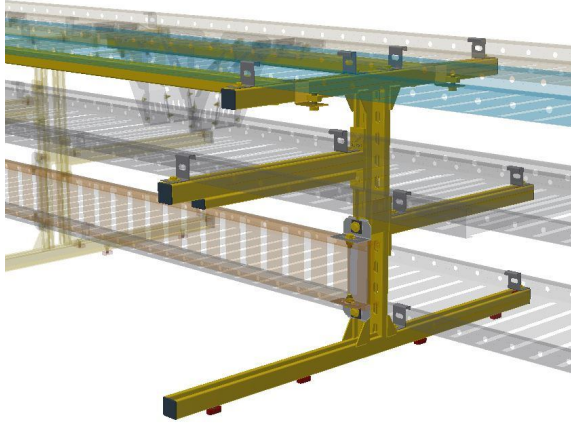

**B15858****- FRAME, T-POD INTRASUITE SUPPORT**

*Frame supporting intra-suite cable trays in T-POD installations. One Frame & accessories only.*

**4000 8775**

**B16025-15****- FRAME, INTRASUITE CABLE T-POD CN1234 SUPPORT**

*Frame supporting inter-suite cable trays in T-POD installations. One Frame & accessories only.*

**4000 8777**

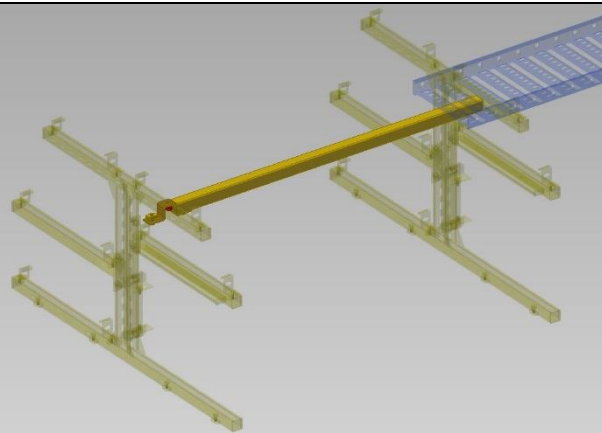
**B16026****- INTRASUITE UNDER TRAY SUPPORT BRACKET KIT**

*Special bracket and 1200 mm LG. channel to install under cable trays as additional support. See also B16026-set.*

**4000 9174**

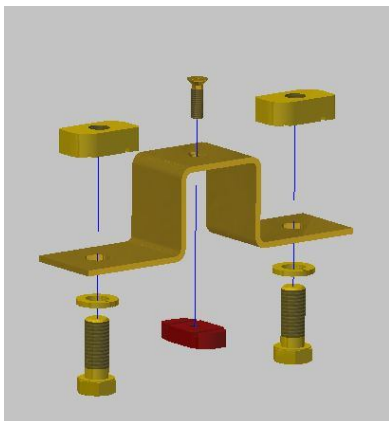
**B16026-SET****- UNDER TRAY SUPPORT BRACKET SET**

*Special bracket to allow installation of channels under cable trays as additional support.*

**4000 9175**

**B16025-17****FRAME-PIPE HURDLE T-POD 1220**

*Frame for installation of overhead cooling agent piping and 'walk-on' inspection panels in 2420mm CTRS T-POD. Frame only.*

**4000 8776**

**B16025-20****FRAME-PIPE HURDLE T-POD 1520**

*Frame for installation of overhead cooling agent piping and 'walk-on' inspection panels in 2720mm CTRS T-POD. Frame only.*

**4000 8778**

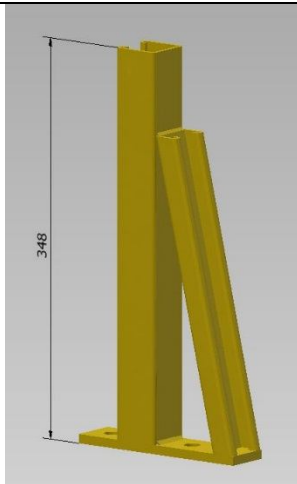
**B16069****CANTILEVER BRACKET 340mm LG. WITH BRACE**

*Bracket used to assemble Frame Pipe Hurdle T-POD*

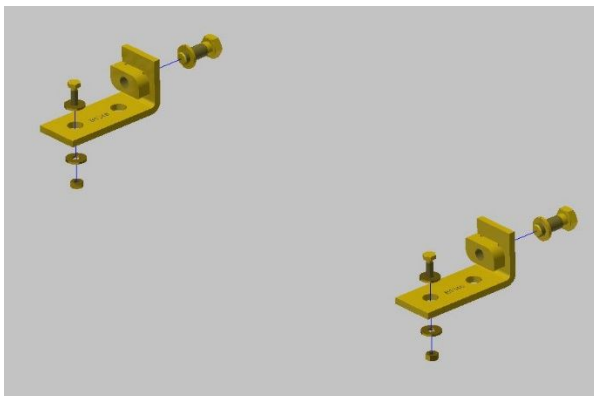
**B16253****KIT – CONTAINMENT STARTER KIT CN1234**

*Set of B1346 brackets and fasteners.*

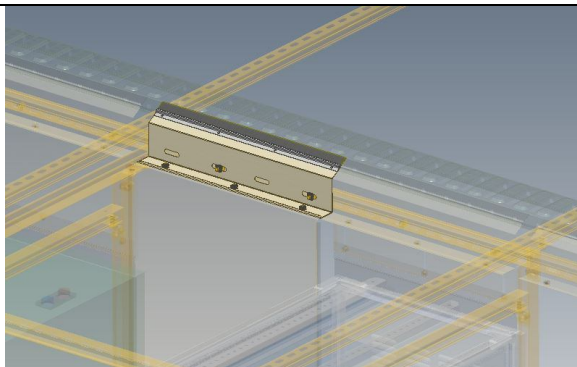
**B16101-01****AIR BARRIER STARTER KIT**

*600mm wide air barrier kit panel mounted to Top Bar above rack.*

**4000 9309**

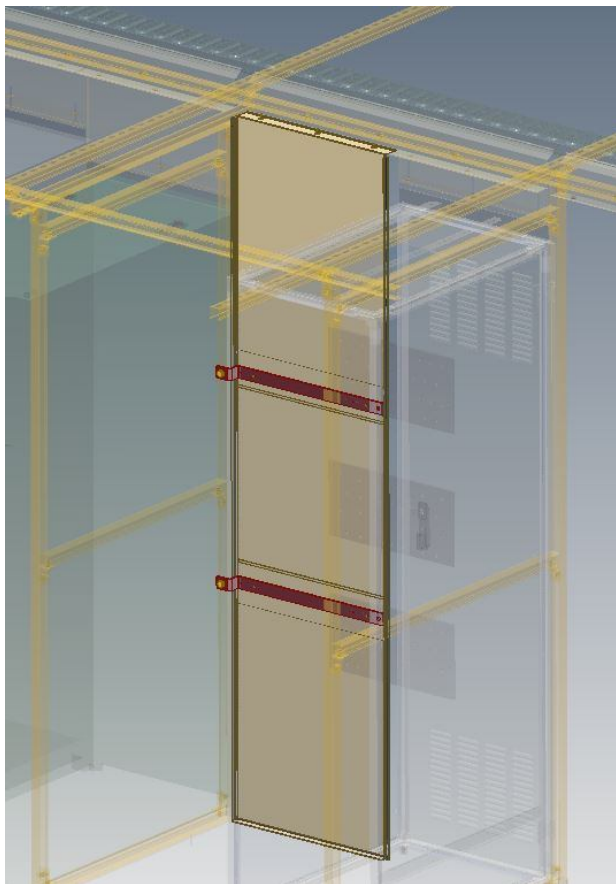
**B16101-02****KIT - AIR BARRIER FULL RACK  
600mm**

*600mm wide air barrier kit panel mounted to Air Barrier Starter.*

**4000 8768**

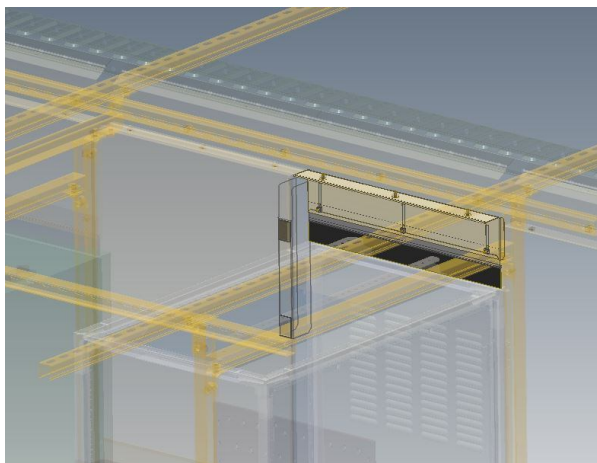
**B16101-03****KIT - AIR BARRIER PANEL  
OVER 2.2M RACKS**

*600mm wide air barrier kit panel mounted to Air Barrier Starter above 2.2-meter-high racks.*

**4000 8769**

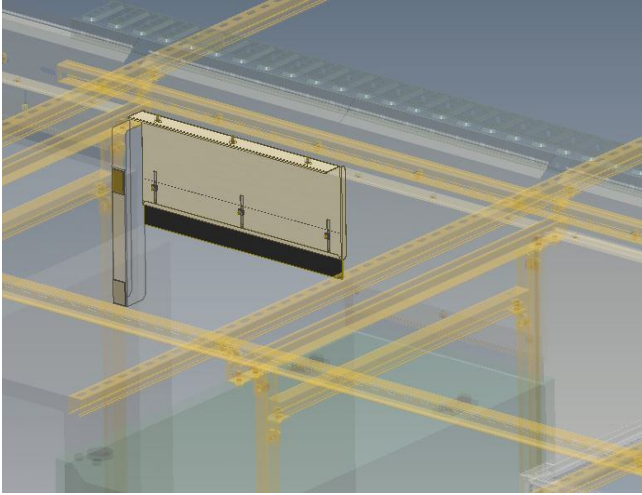

**B16101-04****KIT - AIR BARRIER PANEL  
OVER 2.1M RACKS**

*600mm wide air barrier kit panel mounted to Air Barrier Starter above 2.1-meter-high racks.*

**4000 9310**

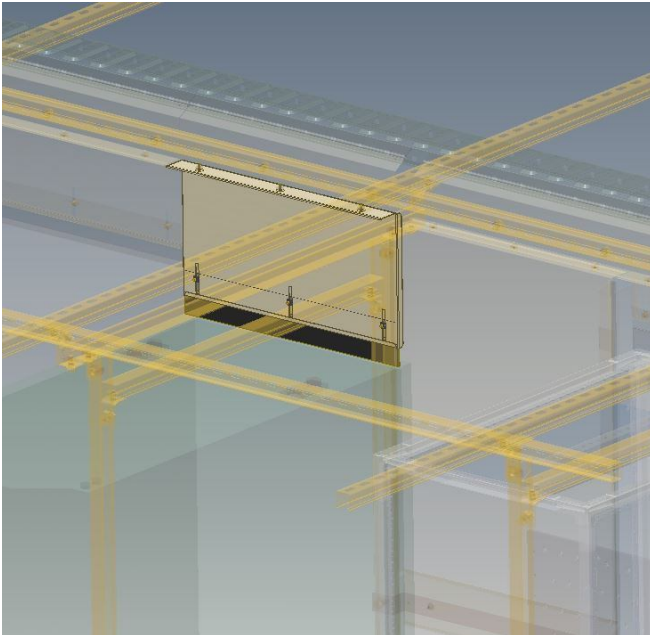
**B16101-05****KIT - AIR BARRIER PANEL  
OVER 2.0M RACKS**

*600mm wide air barrier kit panel mounted to Air Barrier Starter above 2.0-meter-high racks.*

**4000 8770**

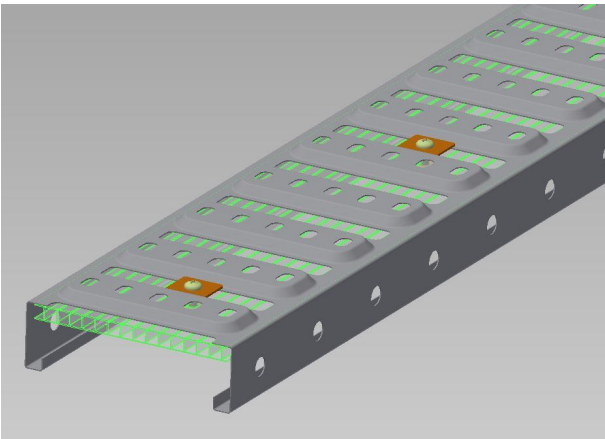
**B15877****KIT – TELTRAY FILLER STRIP  
WITH FASTENERS**

*8 of 3000 M LG **fire-retardant POLYCARBONATE**. Double wall strips and fasteners only to block air gaps in Mezzanine Floor Teltray. NO TELTRAYS.*

**4000 8771**

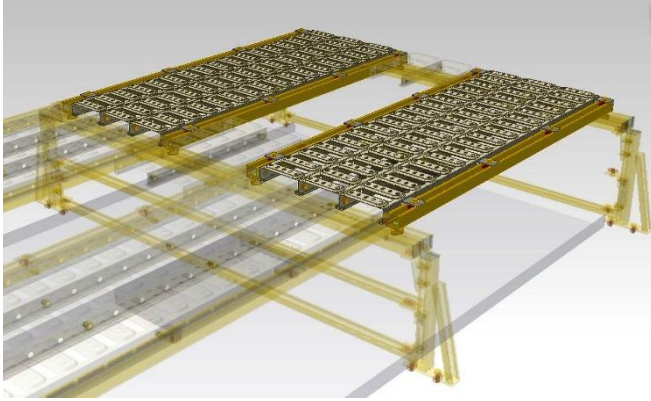
**B16196****- KIT, PANEL-INTRASUITE PIPE T-POD CN1234**

*'Walk-on' inspection panel for pipe hurdle T-POD for 2720mm and 2520mm CTRS installations.*

**4000 9426**

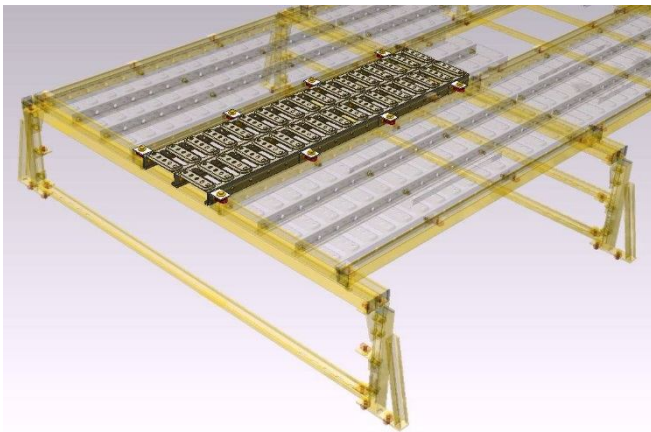
**B16197****- KIT, PANEL - PIPE FILLER T-POD CN1234**

*'Walk-on' filler panel for pipe hurdle T-POD for 2720mm CTRS installations.*

**4000 9424**

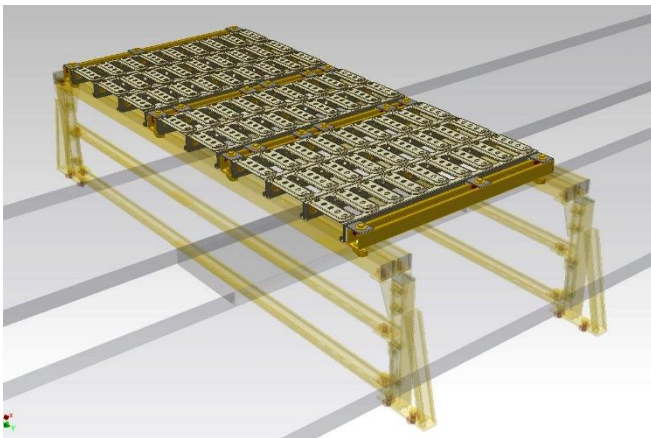
**B16195****- KIT, PANEL-INTRA HALF BAY T-POD CN1234**

*'Walk-on Half Bay' inspection panel for pipe hurdle T-POD for 2720mm and 2520mm CTRS installations.*

**4000 9429**

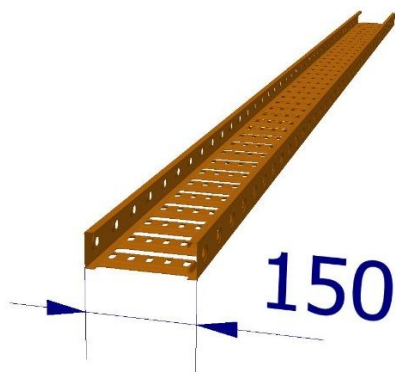
**B15862****- TRAY, CABLE ST3 150mm x 3M ORANGE AC POWER**

*"AC" POWER, CABLE TRAY 150mm x 3m LG. – Cable tray painted orange use in T-POD for AC power cable*

**4000 8774**

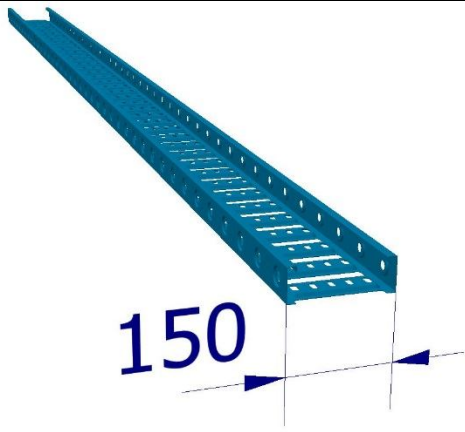
**B15931****- TRAY, CABLE ST3 150mm x 3M BLUE**

*CABLE TRAY 150mm x 3m LG. – Cable tray painted BLUE use in T-POD for optical cable*

**4000 8779**

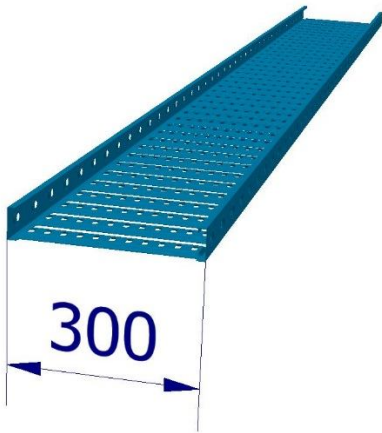
**B15932****- TRAY, CABLE ST3 300MM X 3M BLUE**

*CABLE TRAY 300mm x 3m LG. – Cable tray painted BLUE use in T-POD for optical cable*

**4000 8780**

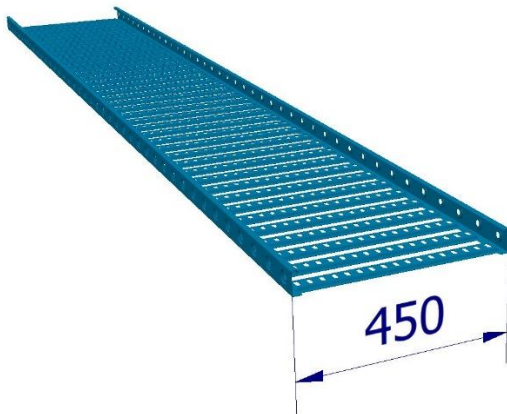
**B15933****- TRAY, CABLE ST3 450MM X 3M AUG2A315 PC**

*CABLE TRAY 450mm x 3m LG. – Cable tray painted BLUE use in T-POD for optical cable*

**4000 8781**

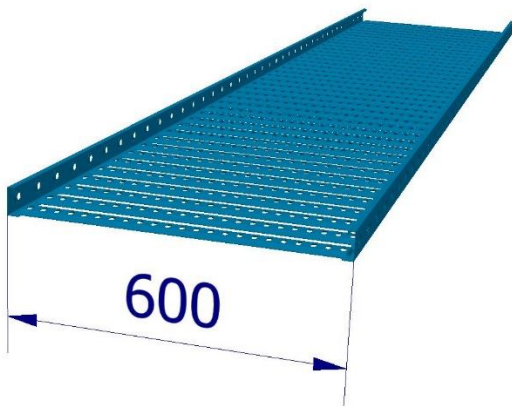
**B15934****- TRAY, CABLE ST3 600MM X 3M AUG2A315 PC**

*CABLE TRAY 600mm x 3m LG. – Cable tray painted BLUE use in T-POD for optical cable*

**4000 8782**

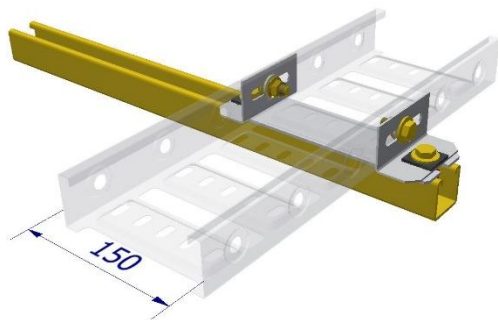
**B15876-150****- KIT, 150MM WIDE CABLE TRAY MOUNTING ISOLATION**

*Kit to mount and electrically isolate 150mm Cable Tray*

-----

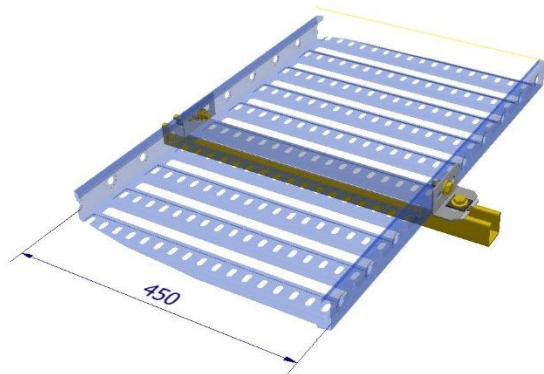
**B15876-450****- KIT, 450MM WIDE CABLE TRAY MOUNTING ISOLATION**

*Kit to mount and electrically isolate 450mm Cable Tray*

**4000 9947**

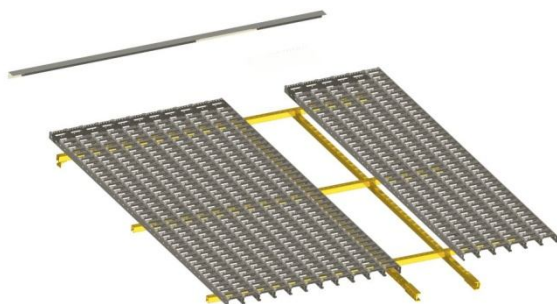
**B9706****- PLANAR TRAY SHELF, MEZZANINE FLOOR MODULE 9 SQM**

*3 x 3 m superstructure module.  
Includes channel iron, Planar tray, brackets and fastening items to assemble a 3 x 3 m section of superstructure platform.*

**35301576**

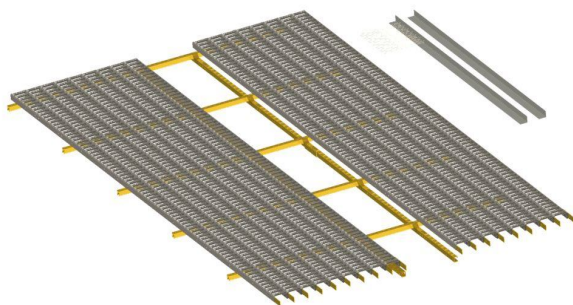
**B9707****- PLANAR TRAY SHELF, MEZZANINE FLOOR MODULE, 18SQM**

*3 x 6 m superstructure module.  
Includes channel iron, Planar tray, brackets and fastening items to assemble a 3 x 6 m section of superstructure platform.*

**35301577**



**B9108****KIT, WALL BAR 3M***Wall bar, brackets, fasteners & insulating items kit.***35301594****B9715****- FRAME, SUITE SUPPORT  
600MM X 2.4M***Pre-assembled Suite End Support Frame 600mm wide  
x 2400mm high.***35300469****B9716****- FRAME, SUITE SUPPORT  
900MM X 2.4M***Pre-assembled Suite End Support Frame 900mm wide  
x 2400mm high.***35301477**

**B9790**

**- FRAME, LOW CEILING (LC) SUITE  
ODF SUPPORT 2.4M FOR W&B HD  
ODF**

*Used in LC NBN installations.*

**35301798.**

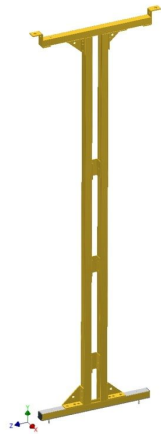
**B9782**

**- FRAME, SUITE ODF SUPPORT 2.4M  
For W&B HD ODF**

*Pre-assembled HDODF Support Frame 600mm wide  
x 2400mm high.*

*Support frames for Iron Work mezzanine floors*

**35301561.**

*Note: replaces part # B9580*

**B9784**

**- SINGLE COLUMN SUPPORT KIT**

*REF to NBN CO document -  
'FAN Construction Work Practices – FAN Ironwork  
and Infrastructure Practices' for application.*

**35301799.**

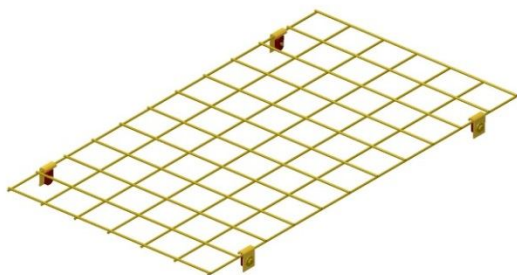
**B9106****- 600MM WIDE RACK MESH KIT**

*600 x 1110 mm section of steel welded mesh, ZA.  
Includes:*

*4 x metal HOLD DOWN BRACKETS & fasteners*

**35302455**

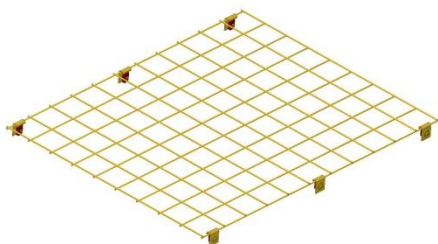
**B9444****- 900MM WIDE RACK MESH KIT**

*900 x 1110 mm section of steel welded mesh, ZA.  
Includes:*

*6 x metal HOLD DOWN BRACKETS & fasteners*

**35301548**

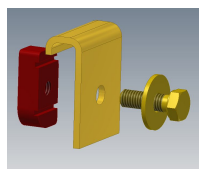
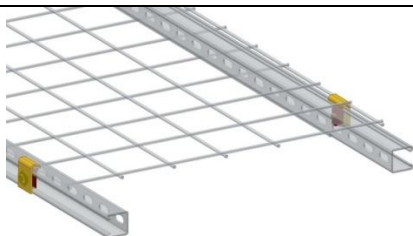
**B9833****- HOLD DOWN BRACKETS FOR RACK MESH**

*Set of 2 Metal Brackets and fasteners for fixing Rack Mesh – replaces plastic Panduit's cable ties, can be retro fitted*

**B10403****- MODULE, 3M LONG GUARD RAIL**

*3 m length safety rail module for fitting at extremities of superstructure builds. Can be installed to mezzanine floor planar shelf trays.*

**35300463**

**B9674-16****- WARNING SIGN ASSEMBLY**

*Access Ladder entry safety chain (800mm. Width) with warning sign.*

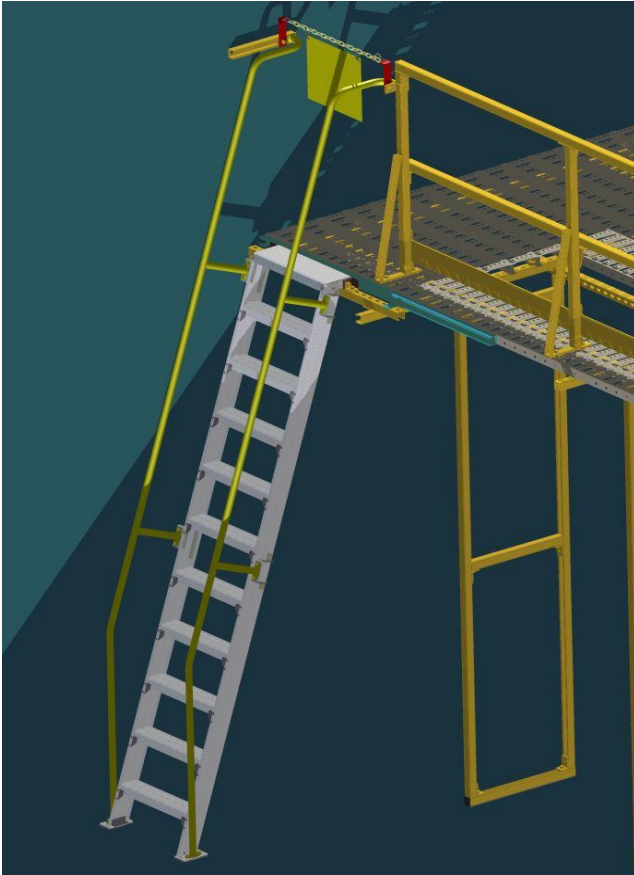
**B9674-2400****- SEMI-PORTABLE ACCESS LADDER TYPE 2.4M**

*superstructure aluminium access ladder.*

**REMARKS:**

*This ladder is designed to be easily unbolted and moved to a new access position where the original access point is no longer required.*

*It is not intended that this ladder be shared between various superstructure access points in an 'ad-hoc' manner.*

*Weight approx. 23 kg.*

**35301592**

**B9674-2900****- SEMI-PORTABLE ACCESS LADDER TYPE 2.9M**

*Superstructure Aluminium access Ladder.*

**REMARKS:**

*This ladder is designed to be easily unbolted and moved to a new access position where the original access point is no longer required.*

*It is not intended that this ladder be shared between various superstructure access points in an 'ad-hoc' manner.*

*Used with high (2.887 m) superstructure. Weight approx. 28 kg.*

**35301593**

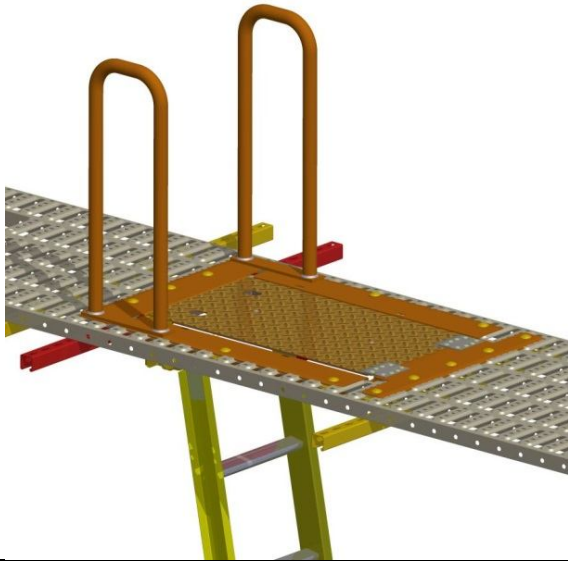

**B14967****MEZZANINE FLOOR ACCESS HATCH**

*Preassembled hatch kit for installing save to Mezzanine Floor. Can be installed to both 2400 & 2887 high Superstructure. Suitable Fiberglass Hook Laded purchase separately. Can be installed in across or parallel positions to Mezzanine floor 'Teltray'.*

**35301914**

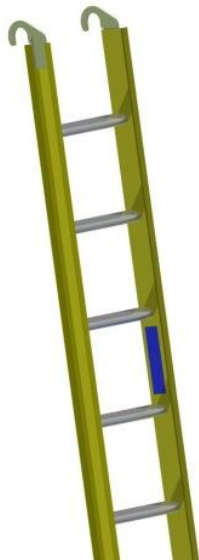
**B14967-09****FIBREGLASS HOOK LADDER FOR 2.4 M SUPERSTRUCTURE**

*Ladder to suit Mezzanine Floor Access Hatch (B14967) installed in 2400 high Superstructure.*

**35301915**

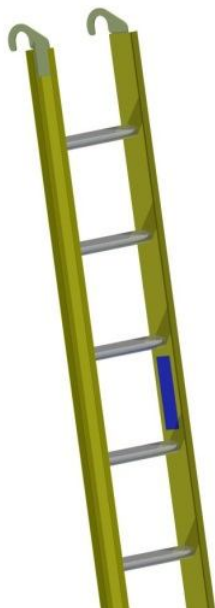
**B14967-12****FIBREGLASS HOOK LADDER FOR 2.887 M SUPERSTRUCTURE**

*Ladder to suit Mezzanine Floor Access Hatch (B14967) installed in 2887 high Superstructure.*

**35301916**

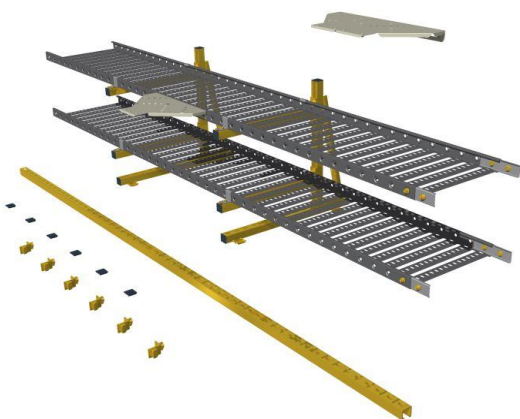
**B9703****KIT, INTERSUITE TRAY FOR SUPERSTRUCTURE IRONWORK**

*Kit of inter-suite support frames and cable tray items required at the end of each equipment suite. Used in all type Superstructure.*

**35301581**

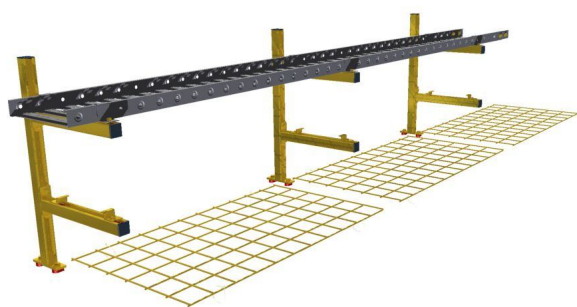
**B9708****- KIT, INTRASUITE TRAY.  
(1520 - 92)**

*Kit of intra-suite support frames and cable tray items required for a single 3 m long equipment suite. Used in 1520mm CRS suits old type superstructure.*

**35301578**

**B9709****- KIT, INTERSUITE TRAY.  
(1520 - 92)**

*Kit of inter-suite support frames and cable tray items required at the end of each equipment suite. Used in old type superstructure.*

**35301579**

**B9702****KIT, INTRASUITE TRAY.  
(1520 – 08)**

*Kit of intra-suite support frames and cable tray items required for a single 3 m long equipment suite. Used with 600mm wide Suite Supports @ 1520mm CRS.*

**35301580**

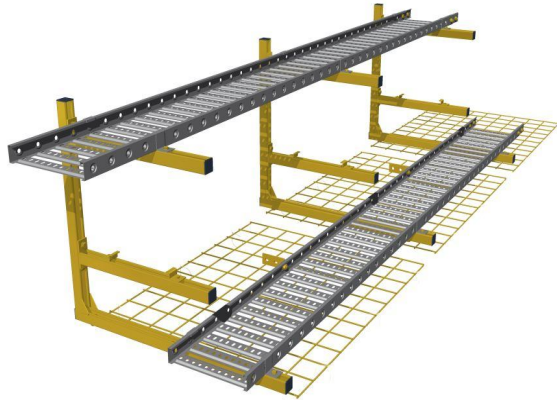
**B9717****KIT, INTRASUITE TRAY.  
(2120 – 08)**

*Kit of intra-suite support frames and cable tray items required at the end of each equipment suite. Used with 900mm wide Suite Supports.*

**35301596**

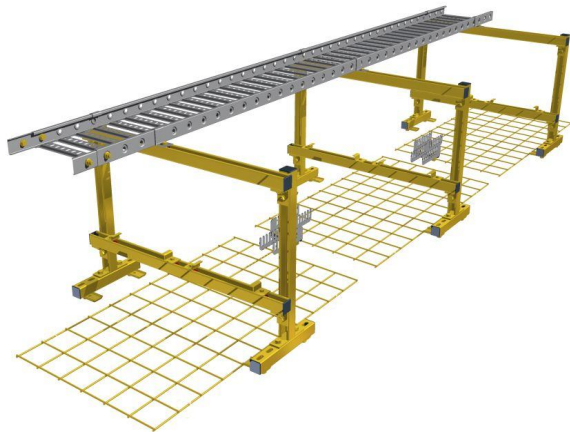
**B9704****KIT, INTRASUITE TRAY  
OFF/OMF.**

*Kit of intra-suite support frames and cable tray items required for a single 3 m long OFF or OMF suite.*

**35301582**

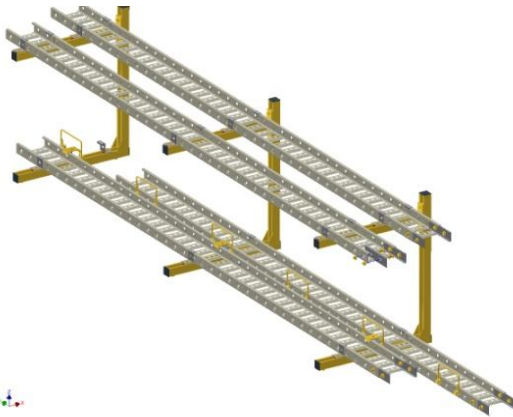
**B9792****KIT, INTRASUITE TRAY for 1520mm  
SUITES C/C IRONWORK**

*Used in NBN installations.*

**35301800.**

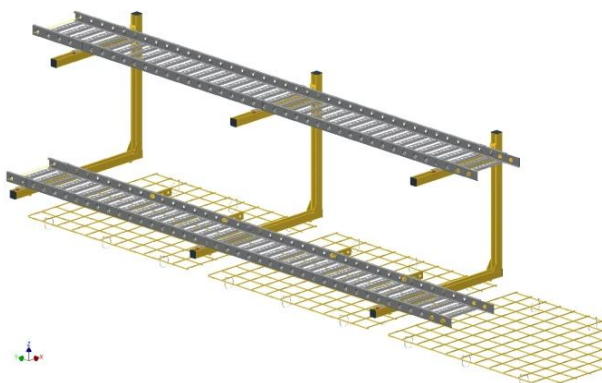
**B9776****- KIT, INTRA-SUITE TRAY for  
2120mm SUITES C/C  
IRONWORK**

*Used in NBN installations.*

**B9777****- LEGACY KIT, INTRASUITE TRAY for 1520mm SUITES C/C IRONWORK**

*Used in NBN installations.*

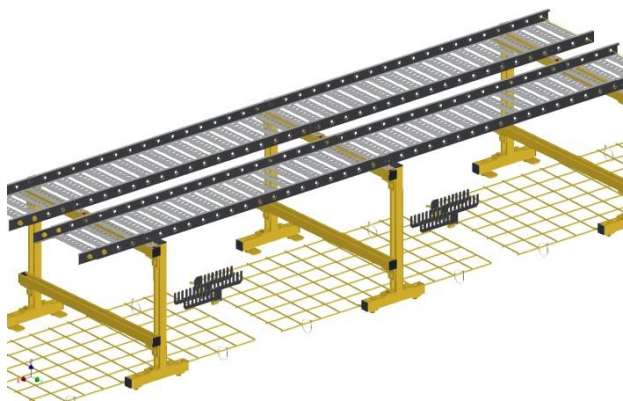
**B9778****- KIT, ODF INTRASUITE CABLE TRAY for NBN**

*Used in NBN installations.*

**B9824****KIT, MC INTERSUITE TRAY**

*Support bracket, fasteners and trays to assemble approx. 3meter of inter suite cable trays in Middle Ceiling ironwork installation.*

**35301836**

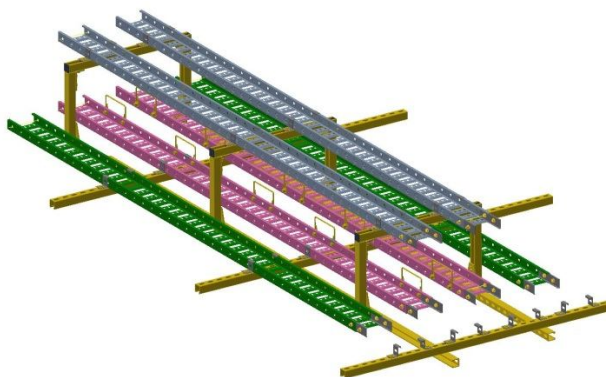
**B9825****KIT, MC INTRASUITE TAY 1520 C/C SUITS**

*Support bracket, fasteners and trays to assemble approx. 3meter of intra suite cable trays in Middle Ceiling in 1520mm suits centres ironwork installation.*

**35301834**



**B9826****KIT, MC INTRASUITE TRAY  
OFF/OMF**

*Support bracket, fasteners and trays to assemble approx. 3meter of intra suite cable trays in Middle Ceiling in OFF/OMF Suits ironwork installation.*

**35301833**

**B9827****KIT, MC INTRA-SUITE TRAY  
2120 C/C SUITS**

*Support bracket, fasteners and trays to assemble approx. 3meter of intra suite cable trays in Middle Ceiling in 2120mm suits centres ironwork installation.*

**35301835**

**B9692****- FRAME, OFF/OMF CABLE  
TRAY & DUCTING SUPPORT.**

*Frame (pre-assembled) to support OFF/OMF intra-suite fibre cable trays and ducting.*

**35301583**

**B9691****- FRAME, INTRASUITE CABLE  
TRAY SUPPORT (1520 – 08)**

*Frame (pre-assembled) to support intra-suite power & fibre cable trays and optical fibre ducting. Used with 600mm wide Suite Supports.*

**35301585**

**B9695****- FRAME, INTERSUITE CABLE TRAY SUPPORT**

*Frame (pre-assembled) to support inter-suite power and optical fibre cable trays up to 450 mm wide.*

**35301586**

**B9710****- FRAME, INTRA-SUITE CABLE TRAY SUPPORT (2120-08)**

*Frame (pre-assembled) to support intra-suite fibre cable trays and optical fibre ducting. Used with 900mm wide Suite Supports.*

**35301595**

**B9087****- FRAME, INTERSUITE CABLE TRAY SUPPORT. (1520-92)**

*Inter-suite support assembly for power trays and optical fibre ducting. Used in older type Superstructure.*

**35301463**

**B9101****- FRAME, INTRASUITE CABLE TRAY SUPPORT. (1520-92)**

*Frame (pre-assembled) to support intra-suite power trays and optical fibre ducting. Used in older type Superstructure.*

**35301584**

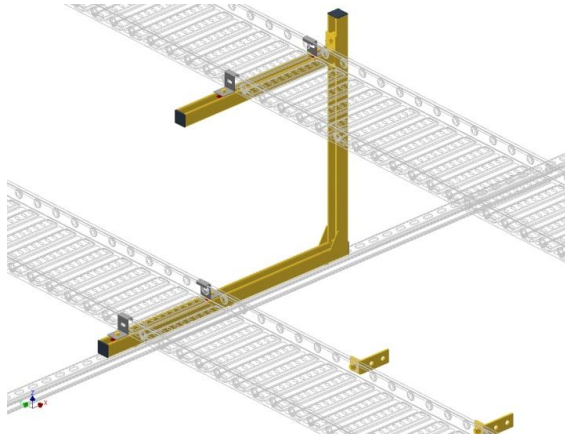
**B9774**

**- FRAME, INTRA-SUITE CABLE TRAY SUPPORT for 2120mm SUITES C/C IRONWORK**

*Used in NBN installations.*

**B9775**

**- LEGACY FRAME, INTRA-SUITE CABLE TRAY SUPPORT FOR 1520mm SUITES C/C IRONWORK**

*Used in NBN installations.*

**B9779**

**- FRAME, ODF INTRA-SUITE CABLE TRAY SUPPORT FOR NBN**

*Used in NBN installations.*

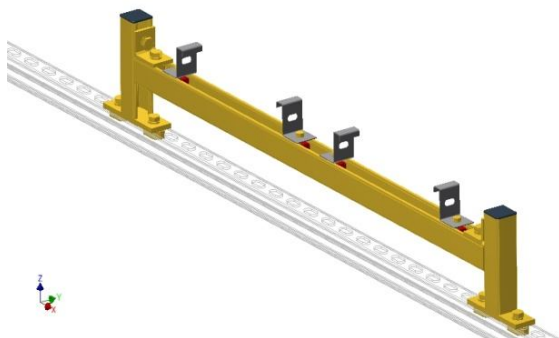
**B9785**

**- ODF SUPPORT BRACKET for CABLE TRAY LC INSTALLATION**

*Brackets and fasteners to mount 2 of 300mm wide Cable Trays in NBN LC installations*

**35301802.**

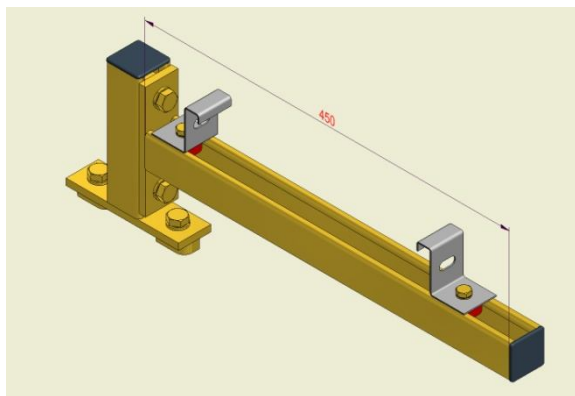
**B9786****- SUPPORT BRACKET for 300mm CABLE TRAY 2120LC INSTALLATION**

*Cantilever (450mm.lg) brackets and fasteners to mount intra suite Cable Tray in NBN LC for Intra-suite Cable Tray installations.*

**35301803.**

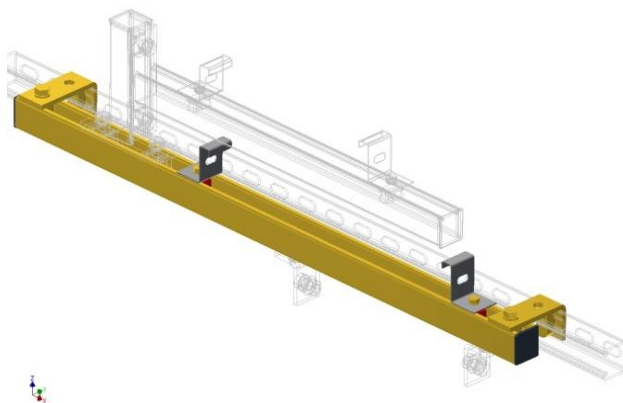
**B9787****- MOUNTING BRACKET FOR INTER-SUITE CABLE TRAY SUPPORTS LC INSTALLATIONS**

*Used to allow installation of cantilever brackets on top bars in NBN LC for Inter-suite Cable Tray installations.*

**35301804.**

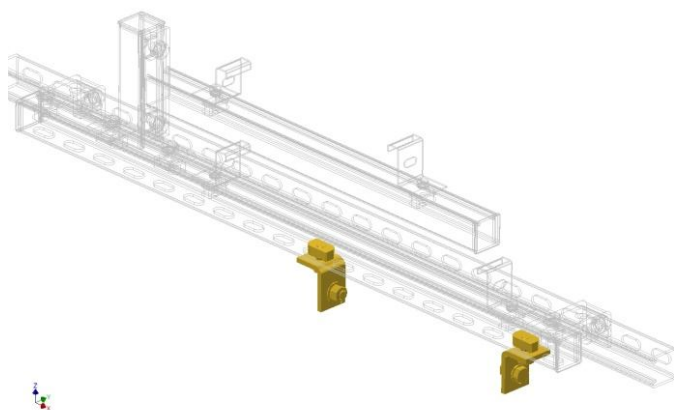
**B9788****- MOUNTING BRACKET WITH FASTENERS**

*P1068 Angle Brackets with fasteners for mounting Cable trays underneath of channels. Used in NBN LC installations.*

**35301805.**

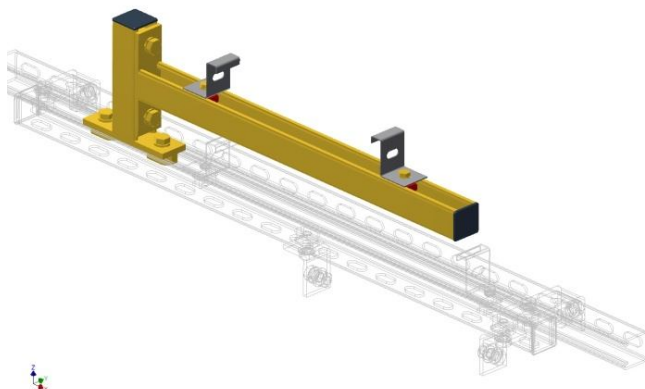
**B9789****- SUPPORT BRACKET FOR 300MM WIDE CABLE TRAY LC INSTALLATIONS**

*Cantilever (550mm.LG) brackets and fasteners to mount Inter suite Cable Tray in NBN LC installations.*

**35301806.**

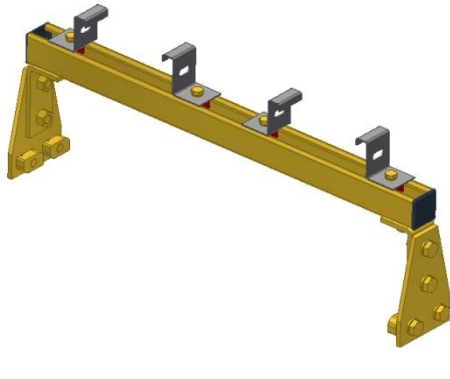

**B9794****- CABLE TRAY SUPPORT BRACKET FOR 1520 C/C LC**

*Used in LC NBN installations.*

**35301807**

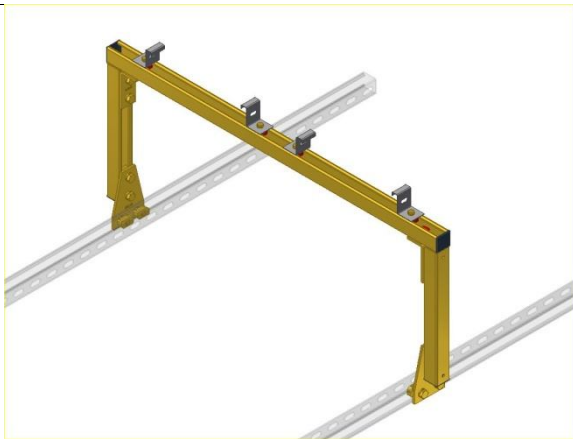
**B9809****- FRAME, INTRA-SUITE CABLE MODULE**

*Intra-suite cable tray support frame for 'MC' installations. Supplied partially assembled.*

**35301821**

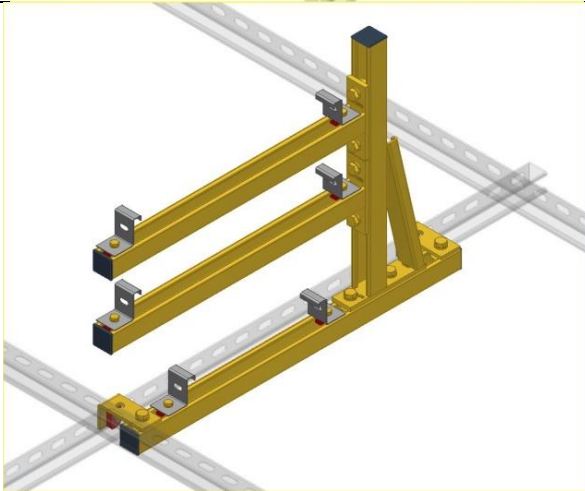
**B9810****- FRAME, INTER-SUITE CABLE MODULE**

*Inter-suite cable tray support frame for 'MC' installations. Supplied preassembled.*

**35301822**

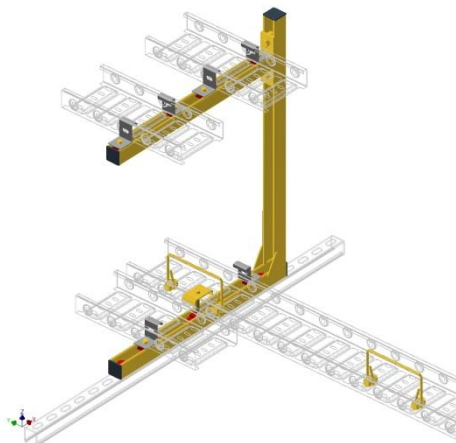
**B9791****- FRAME, INTRA-SUITE CABLE TRAY SUPPORT FOR 1520mm SUITES C/C IRONWORK**

*Used in NBN installations.*

**35301801.**

**B14965****- HIGH TO LOW TRANSITION KIT**

*Bracket, fasteners and isolating items to transition between low (2400) and high (2887) Superstructure.*

**35301913**

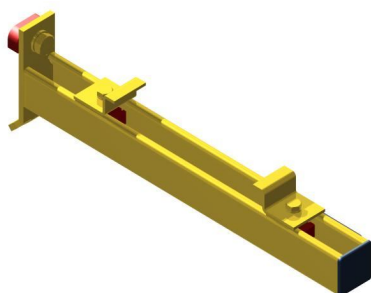
**B10417****- OPTIC FIBRE SUPPORT**

*Optic fibre duct cantilever support bracket (400mm). Can be bolted to existing transmission superstructure vertical support brackets (posts) for the purpose of securing and supporting suite optic fibre ducting.*

**35301464**

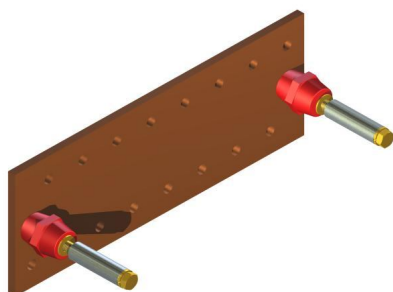
**B9179****- BAR, COMMON COLLECTOR SUITE EARTH LEADS.**

*Common collector bar used for collection of suite earth leads. Fitted with 2 stand-off insulators 50mm HEX M12*

**35300735**

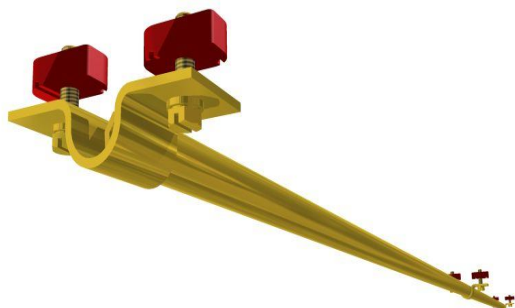
**B9741****- SUPERSTRUCTURE AISLE LIGHTS MOUNTING KIT**

*21 mm DIA tube x 2500 mm LG with saddle clamps and fasteners. Used for mounting lights in superstructure aisle. Lights not included.*

**35301625**

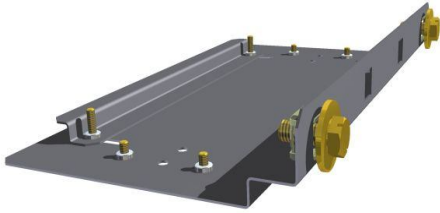
**B9698****- 'ELSAFE' PB2 OUTLET MOUNTING BRACKET KIT**

*Bracket used to mount 240V test outlet modules to the underside of superstructure Planar Tray. Steel, PC, grey.*

**35301591**

**B9828****- KIT - 240V TEST EQUIPMENT OUTLET MOUNTING BRACKET**

*Bracket used to mount 240V test outlet modules to the 21mm DIA light mounting tube. Used in LC & MC installations. Steel, PC, grey.*

**35301844**

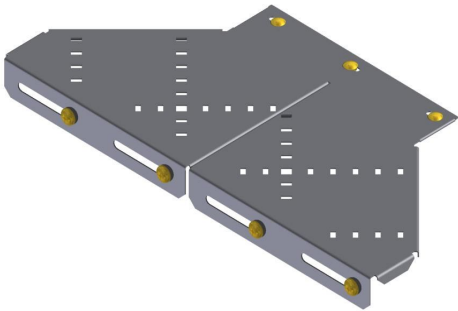
**B9181-08****- T-JOINT BRACKET MODULE FOR 300MM WIDE CABLE TRAY**

*T junction bracket for 300 mm ST3 cable tray. Steel, PC, grey.*

**35301549**

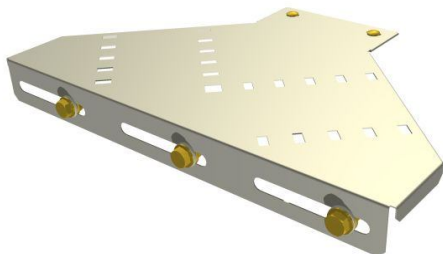
**B9690****- BRACKET, T JUNCTION 150MM CABLE TRAY**

*T junction bracket for 150 mm ST3 cable tray. Steel, PC, grey.*

**35301589**

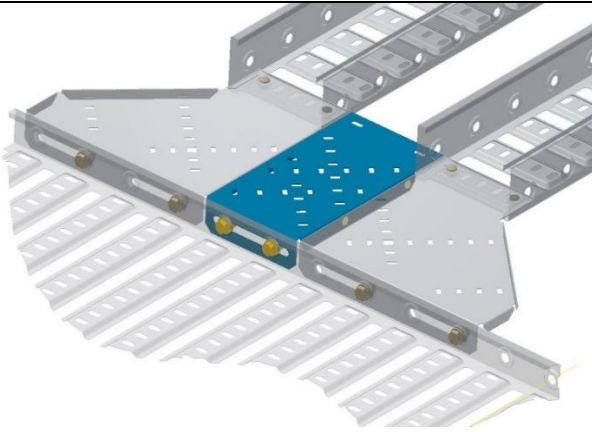
**B9817****- 150mm WIDE UNIVERSAL INFIL BRACKET FOR CABLE TRAY 'T-JOINT'**

*Used to infill gap when joining 2 150mm Cable or used for 450mm wide cable tat Trays with T Junction 300MM (part B9181-08) .part replaces part # B9793*

**35301837.**  
(replaces 353/01797)

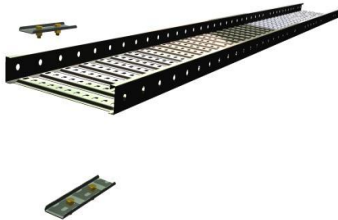
**B9103****- 300mm WIDE. 3mtr. LG. CABLE TRAY KIT**

*Cable tray, 300mm x 3000mm with splicing brackets and fasteners. Powder coated finish. One set. (also ref part B9297 & B9705)*

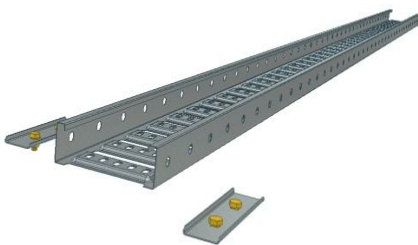
**B9297****-150mm WIDE. 3mtr. LG. CABLE TRAY KIT**

*Cable tray, 150mm x 3000mm with splicing brackets and fasteners. Powder coated finish. One set per kit. (also ref part B9103 & B9705)*

**B9705****- 450mm WIDE. 3mtr. LG. CABLE TRAY KIT**

*Cable tray, 450mm x 3000mm with splicing brackets and fasteners. Powder coated finish. One set per kit. (also ref part B9103 & B9297)*

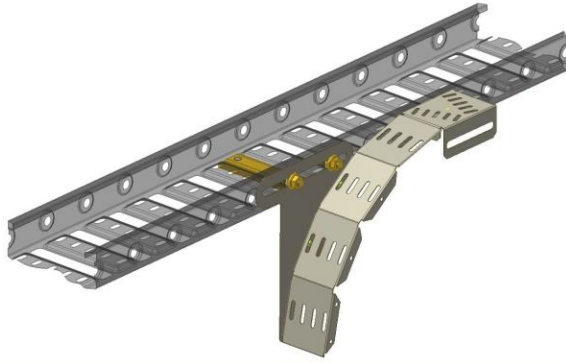

**B9812****- R250x75MM WIDE FIBRE CABLE DROP TRAY KIT**

*Kit of brackets and fasteners to assemble drop tray for fibre cable. 250MM bend radius & approx 250 (H) x 330 (L)*

**35301825**

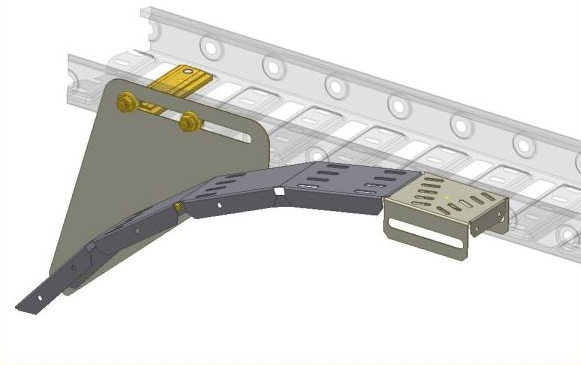
**B9814****- R600x75MM. BEND RADIUS FIBRE CABLE DROP RAMP KIT.**

*Kit of brackets and fasteners to assemble drop tray for fibre cable. 600MM bend radius & approx 250 (H) x 550 (LG)*

**35301826**

**B9689-RH****- 150mm. WIDE R/H CABLE DROP TRAY**

*Cable support assembly installed to manage fibre cables from the suite fibre cable tray down to equipment and racks installed below.*

**35301587**

**B9689-LH****- 150mm. WIDE L/H CABLE DROP TRAY**

*Cable support assembly installed to manage fibre cables from the suite fibre cable tray down to equipment and racks installed below.*

**35301588**

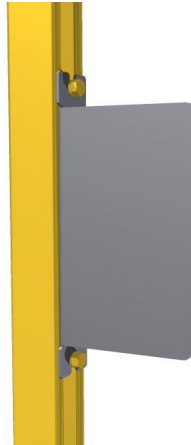
**B9719****- LABEL BRACKET KIT**

*Suite – End label bracket with fasteners.  
Two sets per kit. PC. Label holders not included.*

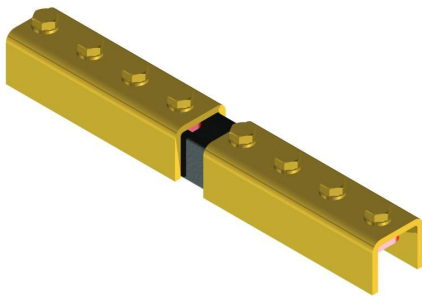
**35301599****B9174****- KIT, CHANNEL ISOLATION BRACKET**

*Superstructure isolating bracket.  
Joiner between superstructure builds.  
Includes Fibreglass channel.*

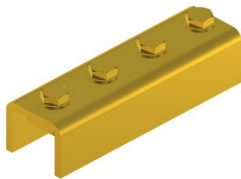
**35300496****B9107****- P1000 CHANNELS EXTENSION KIT**

*Bracket and fasteners to allow extending P1000 & P1000T channels. One set per kit.*

**B9178****- CHANNEL TYPE P1000T – SLOTTED 3M LG.**

*Steel channel [41x41x2.5x3000] slotted*

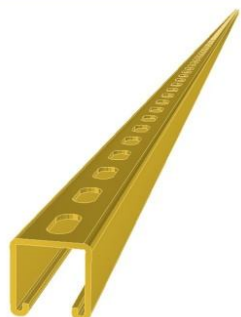
**35300451****B9481-01****- CHANNEL TYPE P1000T – SLOTTED 6000MM LG.**

*Slotted channel zinc plated yellow gold.*

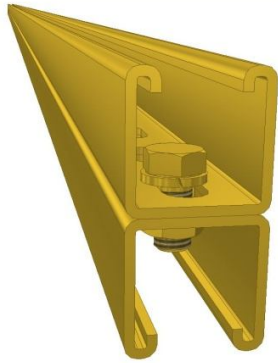
**B9481****- DOUBLE CHANNEL BOLTED – 6000MM.LG.**

*Two of 6 meter long slotted channels bolted back to back.*

**35302062**

**B9666****- DYNA BOLT KIT**

*Pack of 12 M10x80 Dyna Bolts.*

**B9767****- ISOLATING DYNA BOLT KIT**

*Pack of 4 M10x80 Dyna Bolts with isolating plates and M12 flat washers. Used for fixing wall bars.*

**B9743****- CABLE TIE BRACKET FOR CABLE TRAY**

*Bracket mounted on side of cable tray. Used to organise cables. Cable ties not included.*

**35301637**

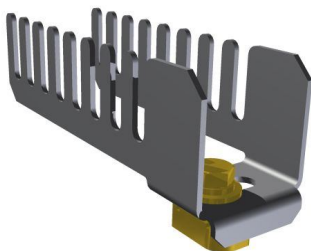
**B9694****- CABLE TIE BRACKET SET.**

*Cable tie bracket to manage cables where they are routed to respective HDODF racks in OFF/OMF suites. Steel, PC, grey.*

**35301590**

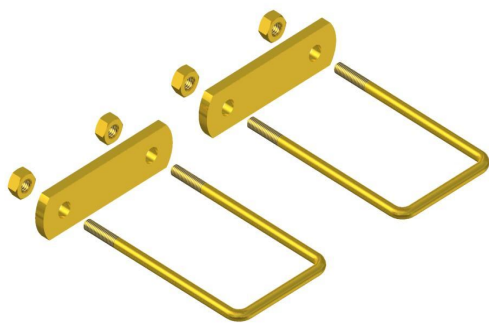
**B8359****- U-BOLTS 64x109**

Set of two U-bolts 64mm x 109mm with fasteners.

35300236

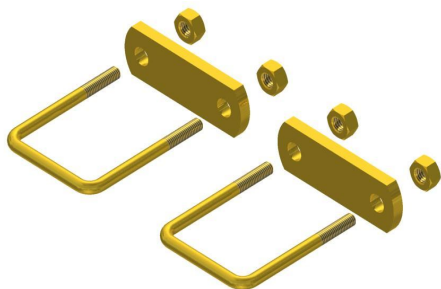
**B8360****- U-BOLTS 54x71**

Set of two U-bolts 54mm x 71mm with fasteners.

35300237

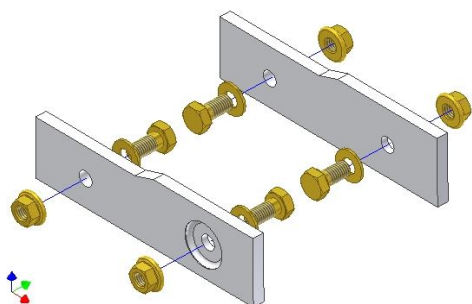
**B9486-02****- CABLE TRAY TRANSITIONAL ISOLATION SPLICE KIT**

Splice plates used to isolate Cable Trays with a 20mm. gap between 45mm(old type) and 50mm cable trays (current).

35301568

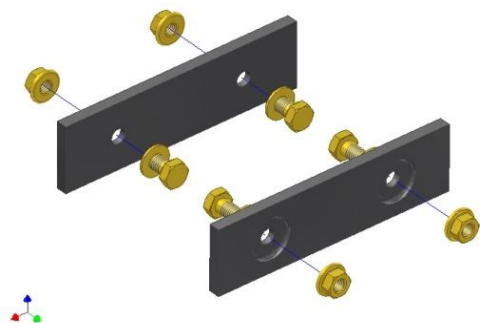
**B9486-01****- CABLE TRAY ISOLATION SPLICE KIT**

- Splice plates used to isolate Cable Trays with a 20mm. gap.

35301567

**B9172****- KIT, ISOLATING FOR WALL BARS**

Kit of insulating items required to electrically isolate superstructure wall bars where they are bolted to building walls.

35300472

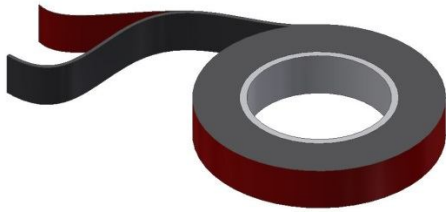

**B15151****- 2.3mmTH. SELFADHESIVE, DOUBLE-SIDED ISOLATING TAPE (25mm WIDE)**

*Tape used to bond and isolate items in Superstructure installations*

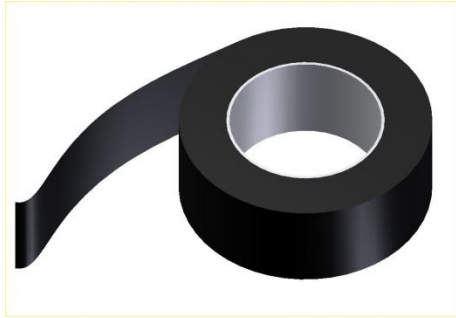
**B9760****- SELF-ADHESIVE ISOLATING TAPE (48mm W)**

*Tape used to isolate Single Support Column (part # B9784) when/if installed close to the wall.(48mm wide x 30.5mtr. long roll)*

**35301810**

**B9180****- KIT, RACK ISOLATION FOR RACK MOUNTING**

*Kit of items required to electrically isolate and bolt equipment rack top frame brackets to 2.4 m superstructure suite top bars.*

**35300555**

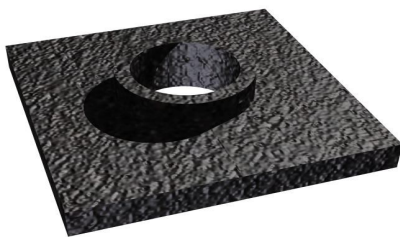
**B9175****- WASHER, ISOLATING WALL BAR**

*Pack of 20 wall bar isolating plates. 30 mm x 30 mm x 4 mm thick. Centred 10.5 mm ID hole with 13.5 mm OD 3 mm raised edge.*

**35300745**

**B9176****- WASHER, ISOLATING RACK TOP**

*Pack of 20 isolating plates. 30 mm x 44 mm x 3 mm thick. Centred 10.5 mm ID hole.*

**35300747**

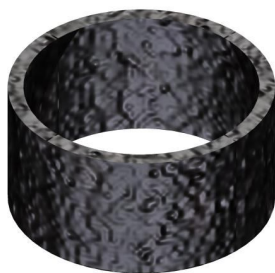
**B9177****- TUBE, ISOLATING RACK TOP**

*Pack of 20 Isolating tube to electrically insulate the thread of the M10 bolts used to secure rack top brackets to superstructure top bars. 6 mm long.*

**35300748**

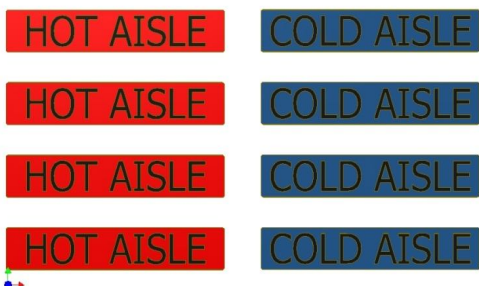
**B9730****- AISLE MARKING LABEL SET**

*Set of self adhesive labels. Used for marking aisles in superstructure installations. 4 off each.*

**35301626**

**B9287****- ANGLE BRACKET - KIT**

*One only B1068 bracket with fasteners used to connect intersecting P1000 type channels in superstructure. 5 sets per kit.*

**B9288****- TWO ANGLE BRACKETS - KIT**

*Two B1068 brackets with fasteners used to connect Top Bar to Wall Tie Bar in superstructure. 5 sets per kit.*

**B9290****- U SHAPED BRACKET - KIT**

*Bracket type B1047 with fasteners. 5 sets per kit.*

**B9529****- M12x24 SCREWS KIT**

*Pack of 50 M12x24 screws and spring washers.*

**B9667****- M8 SPECIAL FASTENERS KIT**

*Pack of 50 M8x25 HHD screws, spring washers and special nut with spring*

**B9485****- SPECIAL NUT M12**

*Pack of 50 M12 Special nuts with tapered spring.*

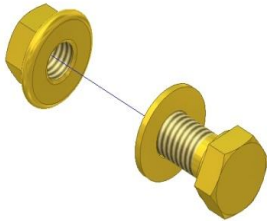
**B9626****- PLANAR SHELF TRAY BOLTING FASTENERS KIT**

*Pack of 50 M10x20 screws, flat washers and hexagonal flanged nuts*

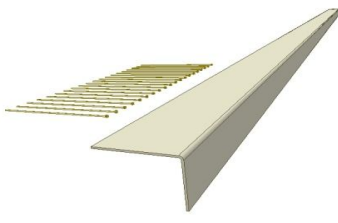
**B9625****- FLASHING ANGLE KIT**

*3mtr. lg. plastic 90 deg. Angle and 20 off cable ties for protecting sharp tray edges in Superstructure installations.*

**35301670**

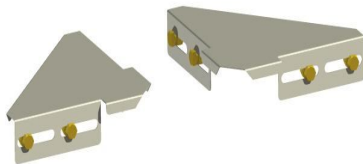
**B9105****- 'T' JOINT KIT FOR CABLE TRAYS**

*Parts and fasteners allowing to build right angle join between all ranges of cable trays width. Powder coated finish. One set per kit.*

**B9802**

**- KIT, CABLE TRAY SIDE  
EXTENSION PANELS  
1200mmLG.**

*Set of 2 1200mm long Cable Tray Side Extensions Panels with fasteners to help manage fibre cables. Used in NBN installations.*

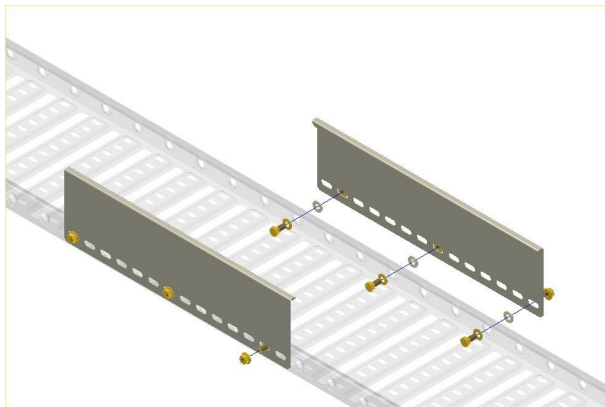
**B9803**

**- KIT, CABLE TRAY SIDE  
EXTENSION PANELS 533mmLG.**

*Set of 2 533mm long Cable Tray Side Extensions Panels with fasteners to help manage fibre cables.*

*Used in NBN installations.*

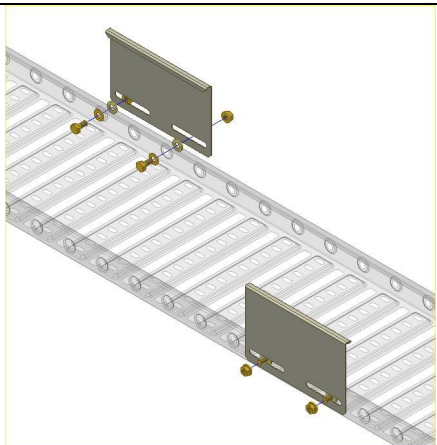
**B9804**

**- KIT, CABLE TRAY SIDE  
EXTENSION PANELS 230mmLG.**

*Set of 2 230mm long Cable Tray Side Extensions Panels with fasteners to help manage fibre cables.*

*Used in NBN installations.*

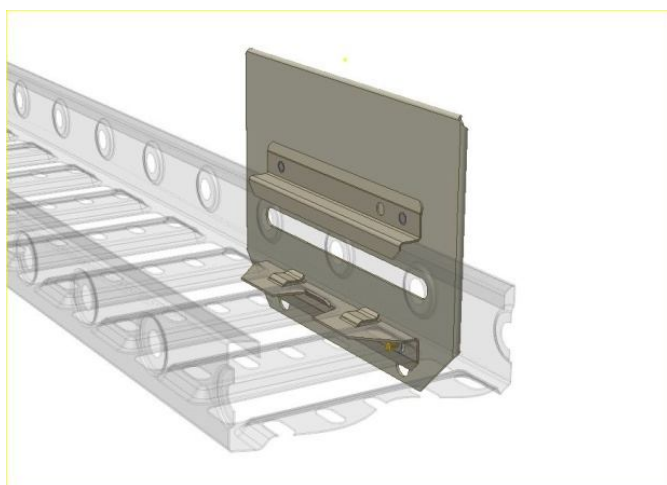
**B9815**

**Cable Tray 'ADD-ON' Side cable  
Management Kit**

*Kit of brackets and fasteners to extend Cable tray side by 70mm (H) x 200mm (LG)*

**35301829**

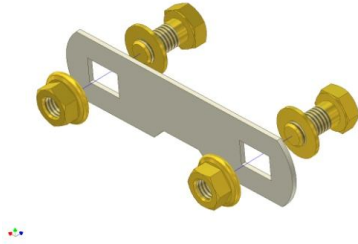

**B9423****- RISER LINK KIT**

*Riser Link Kit with fasteners. Powder coated finish and zinc plated fasteners. 12 sets per kit.*

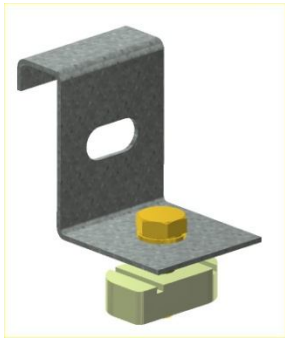
**B9424****- CABLE TRAY HOLD DOWN BRACKET KIT - GB**

*Hold down bracket for Cable trays, including fasteners. Galvabond and zinc plated fasteners. 10 sets per kit.*

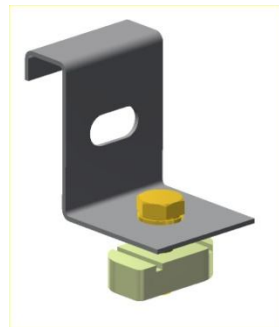
**B9425****- CABLE TRAY HOLD DOWN BRACKET KIT - PC**

*Hold down bracket for Cable trays including fasteners. Powder coated finish and zinc plated fasteners. 10 sets per kit.*

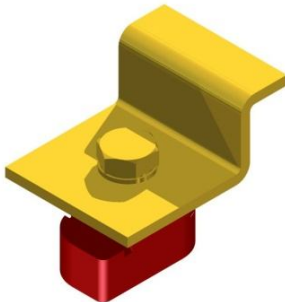
**B9561****- OPTICAL DUCT HOLD DOWN BRACKET KIT**

*Pack of 10 Hold Down brackets for W&B plastic Optical Ducts (all widths) with fasteners. To be used with Telstra standard duct supports.*

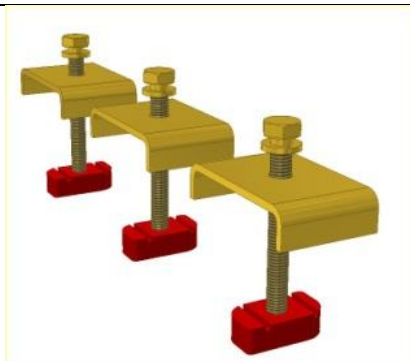
**B9816****SET, DOUBLE SIDED HOLD DOWN BRACKET FOR CABLE TRAYS.**

*3 of Hold Down Brackets with fasteners for Cable Trays.*

**35301827**

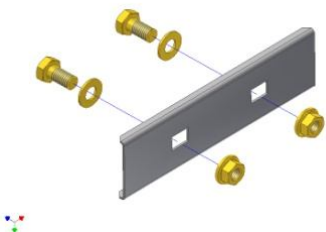
**B9559****- CABLE TRAY JOINER KIT - PC**

*Pack of 10 Powder Coated Splice Plates for Cable Trays with fasteners.*

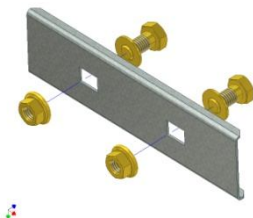
**B9560****- CABLE TRAY JOINER KIT - GB**

*Pack of 10 Galvabond Splice Plates for Cable Trays with fasteners.*

**B9665****- LARGE CABLE TIE KIT**

*Pack of 12 Cable ties Panduit Large – use to fix Rack Mesh (safety mesh) to superstructure over the cabinets.*

**B9669****- SMALL CABLE TIE KIT**

*Pack of 20 smaller size cable ties – use to organize cable in superstructure installations.*

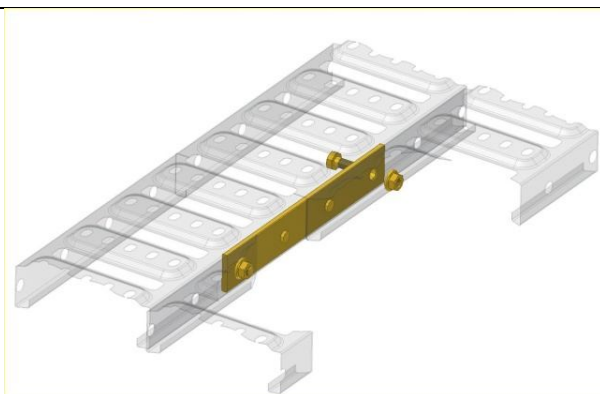
**B9813****- PLANAR SHELF TRAY STRUCTURAL JOINER KIT**

*Set of 10 structural 'Planar Shelf Tray Joiner Plates' with fasteners.*

**35301823**

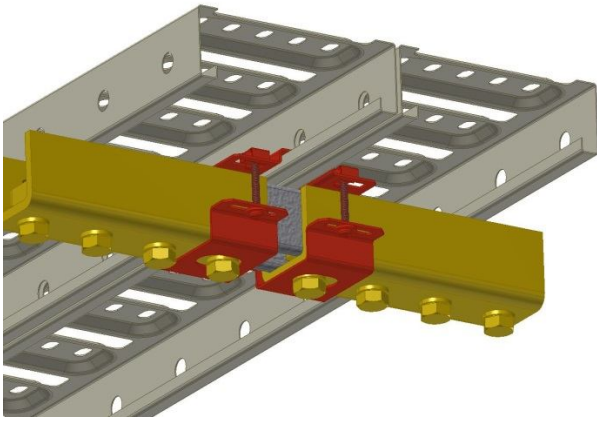
**B14925****- HOLD DOWN BRACKET FOR ISOLATION JOINS**

*Set of 2 Hold Down Brackets with fasteners for planar shelf trays. Used where 'Teltray' sit - over isolating joints*

**35301907**

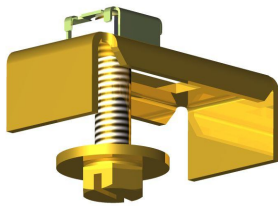
**B9119****- HOLD DOWN BRACKET FOR PLANAR SHELF TRAY**

*Hold down bracket B9755-01 with fasteners for planar shelf trays. Purchased in lots of 5.*

**35301467**

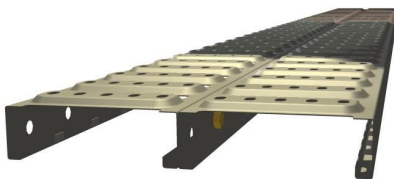
**B9114****- 300mm. WIDE, 3 M. LG. JOINED PLANAR TRAY.**

*Two pre-assembled 150mm x 3000mm Planar Shelf Trays bolted side by side. PC coated.  
(also ref part B9100 & B0150 PC)  
**35300454***

**B0150 PC****- PLANAR SHELF TRAY 150mm WIDE**

*3 meter LG. Planar Tray (also ref part B9100 & B9114)*

**35302354**

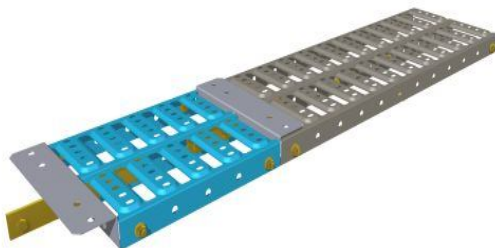
**B9711****PLANAR SHELF TRAY REGISTER INFILL (300x300)**

*Length of planar shelf trays to be installed in superstructure aisle ways and left in place until air conditioning ducting (300x300) and associated registers are installed.*

**35301597**

**B9712****PLANAR SHELF TRAY  
REGISTER INFILL (700x300)**

*Length of planar shelf trays to be installed in superstructure aisle ways and left in place until air conditioning ducting (700x300) and associated registers are installed.*

**35301598**

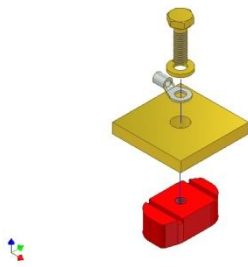
**B9571****- EARTH LEAD CONNECTION  
KIT**

*Pack of 10 fasteners (M8) to connect earth lead from racks to superstructure member. Cable lug not supplied*

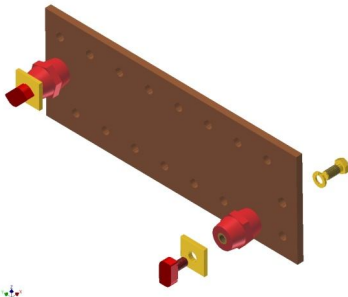
**B9783****- EARTH COLLECTOR COPPER BAR  
(160x425) KIT**

*Used in NBN installations.*

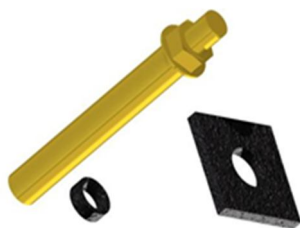
**B9434****- RITTAL RACK ISOLATION &  
ANCHOR COMPONENT**

*Pack of anchor, isolating tube and plate.*

**35301256**

**B10415-03****- SUPPORT FRAMES FOR SINGLE SIDED (SS) MODULE, 9 LATERALS**

*Pre-assembled Support Frames – End Frame (B10415-01) and End Support Frame (B10415-02) - including parts and fasteners to build a 9 lateral DS DDF (2400mm high).*

*Frames are required only when starting new installation, and compliment module 35300397. Not required for extending existing DDF.*

**35300398****B10414-03****- DOUBLE SIDED (DS) MODULE, 4 VERTICALS, 12 LATERALS**

*Pre-assembled Main Supports including parts and fasteners to build a 4 vertical, 12 lateral high DS DDF (2887mm).*

*New installation requires an additional module 35300462 – End Support Frames*

**35300207****B10415-04****- SINGLE SIDED (SS) MODULE, 2 VERTICALS, 9 LATERALS**

*Pre-assembled Main Supports including parts and fasteners to build a 2 vertical, 9 lateral high SS DDF (2400mm).*

*New installation requires an additional module 35300398 – End Support Frames*

**35300397**



**B10404-25****- SUPPORT FRAMES FOR DOUBLE SIDED (DS) MODULE, 9 LATERALS**

*Pre-assembled Support Frames – End Frame (B10404-01) and End Support Frame (B10404-02) - including parts and fasteners to build a 12 lateral DS DDF (2400mm high). Frames are required only when starting new installation, and compliment module 35300399. Not required for extending existing DDF.*

**35300400****B10416-03****SUPPORT FRAMES FOR SINGLE SIDED MODULE, 12 LATERALS**

*Pre-assembled Support Frames – End Frame (B10416-01) and End Support Frame (B10416-02) - including parts and fasteners to build a 12 lateral DS DDF (2887mm high). Frames are required only when starting new installation, and compliment module 35300401. Not required for extending existing DDF.*

**35300402****B10414-04****-SUPPORT FRAMES FOR DOUBLE SIDED (DS) MODULE, 12 LATERALS.**

*Pre-assembled Support Frames – End Frame (B10414-01) and End Support Frame (B10414-02) - including parts and fasteners to build a 12 lateral DS DDF (2887mm high). Frames are required only when starting new installation, and compliment module 35300207. Not required for extending existing DDF.*

**35300462**

**B10404-24****- DOUBLE SIDED (DS) MODULE,  
4 VERTICALS, 9 LATERALS**

*Pre-assembled Main Supports including parts and fasteners to build a 4 vertical, 9 lateral high DS DDF (2400mm).*

*New installation requires an additional module 35300400 – End Support Frames*

**35300399****B10416-04****- SINGLE SIDED (SS) MODULE,  
2 VERTICALS, 12 LATERALS**

*Pre-assembled Main Supports including parts and fasteners to build a 2 vertical, 12 lateral high SS DDF (2887mm).*

*New installation requires an additional module 35300402 – End Support Frames*

**35300401****B9286****- JUMPER RING KIT**

*Jumper Ring used in MDF installations with fasteners. 12 sets per kit.*

**B9116****- DDF JUMPER PLATE WITH  
FASTENERS - KIT**

*Jumper Plate for DDF supplied with fasteners.*

**B9289****- JUMPER PLATE FOR MDF - KIT**

*Jumper plate used in MDF installations with fasteners. 12 sets per kit.*

## DISCONTINUED OR REDUNDANT ITEMS

(Subject to availability)

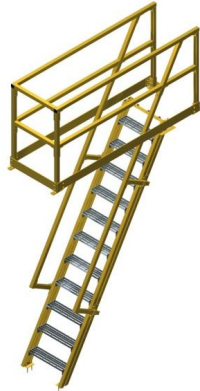

**B9168**

### - LADDER,S/STRUCT PERMANENT 2.4M CN1234

Parts and fasteners required for building an access ladder for a 2400mm high superstructure mezzanine floor. Kit provided with guard rails.

353/00471

*(Alternate aluminium ladder ref. to B9674-2400)*



**B9156**

### - ACCESS LADDER 2887mm HIGH

Parts and fasteners required for building an access ladder for a 2887mm high superstructure mezzanine floor. Kit provided with guard rails.

353/00278

*(Alternate aluminium ladder ref. to B9674-2900)*

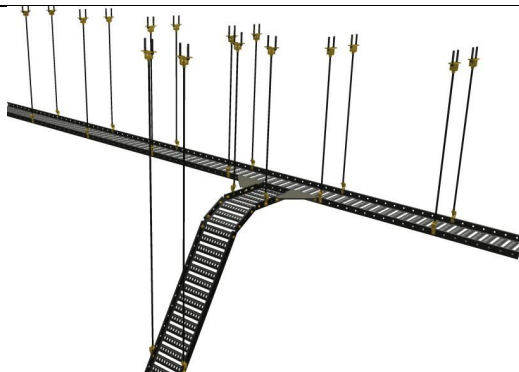

**B9171**

### - EXTERNAL CABLE TRAY MODULE

Parts supplied to build Cable Tray suspended from ceiling with cable drop/rise to lower/higher level.

353/00234



**B9102**

### - 16A Support to 16B Support CONVERSION KIT

Unassembled parts to allow installation of part B9101 (Intra-suite Support) on planar shelf trays (as Inter-suite support). Application as per dwg B8361 Sh 16 pg 2. (ref B9087). One set.



### **B8361-18 SQM**

#### **- SUPERSTRUCTURE MODULE 18m<sup>2</sup>**

Parts and fasteners required to build a mezzanine floor over 18 square metres (6x3).

Suite/End Support frames (35300453 or 35300469) are not included and need to be purchased separately in quantities to suit floor plan. OF Duct not included.

**353/00276**

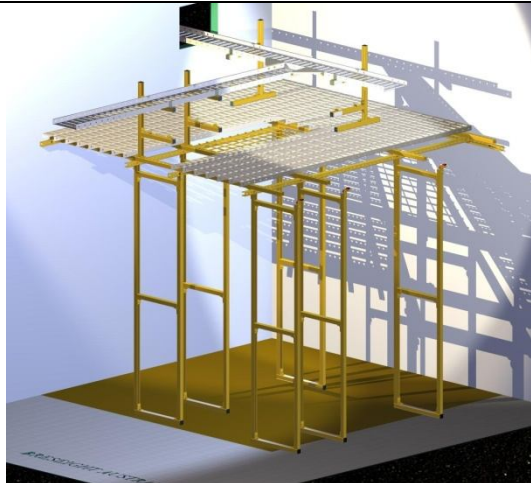

### **B8361-09 SQM**

#### **- SUPERSTRUCTURE IRON WORK MODULE 9m<sup>2</sup>**

Parts and fasteners required to build a mezzanine floor over 9 square metres (3x3).

Suite/End Support Frames (35300453 or 35300469) are not included and need to be purchase separately in quantities to suit floor plan. OF Duct not included.

**353/00450**

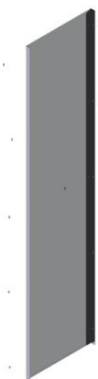

### **B9169-600X2900**

#### **- COVER, SUITE END SUPPORT BRACE**

End Cover for Suite/End Support Frame 600mm wide x 2887mm high.

Fasteners supplied.

Compliments module No. 35300453

**353/00452**



### **B9169-600X2400**

#### **- COVER, SUITE END SUPPORT BRACE**

End Cover for Suite/End Support Frame 600mm wide x 2400mm high.

Fasteners supplied.

Compliments module 35300469

**353/00467**

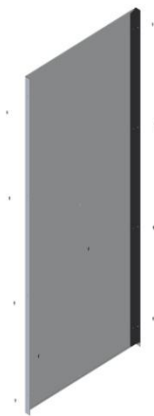

**B9169-900x2400****- COVER, SUITE END SUPPORT BRACE**

End Cover for Suite/End Support Frame 900mm wide x 2400mm high. Fasteners supplied.  
Compliments module B9124-900x2400

**B9173****- INTERSUITE CABLE MODULE**

Parts and fasteners required to interconnect suits over existing trays.

**353/00490**

**B9294 STR****- GUARD RAIL – STARTER KIT**

*Guard rail to be mounted on Tie Bars or Planar Shelf Trays @ 1251mm CTRS*  
*Fasteners for both types of installations are included.*  
*For longer installations part B9294 EXT is required.*  
*Each segment of Guard Rail extends by 1251mm.*  
*Assembly / installation instructions provided with purchased kit.*

**B9294 EXT****- GUARD RAIL – EXTENSION KIT**

Guard rail to be mounted on Tie Bars or Planar Shelf Trays @ 1251mm CTRS  
Fasteners for both types of installations are included.  
Each segment of Guard Rail extends by 1251mm.  
when added to Starter Kit (B9294 STR)  
Assembly / installation instructions provided with purchased kit.

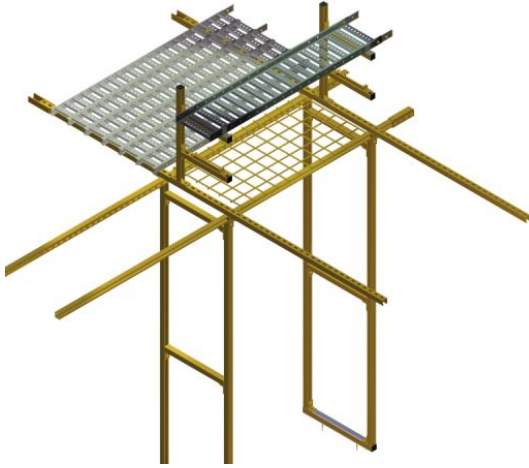
**B9099****- OVERHEAD IRON WORK – 4m<sup>2</sup>.  
EXTENSION MODULE**

Parts and fasteners required for minimum superstructure build.  
Suite / End Supports not included and have to be purchased separately.

**B9579****- HDODF SUPPORT FRAME**

Pre-assembled HDODF Support Frame 600mm wide x 2887mm high.  
Support frames for Iron Work mezzanine floors

**353/01560****B9757****- FRAME SUITE SUPPORT  
600x2.9M**

Pre-assembled Suite End Support Frame 600mm wide x 2887mm high.  
Support frames for Iron Work mezzanine floors.

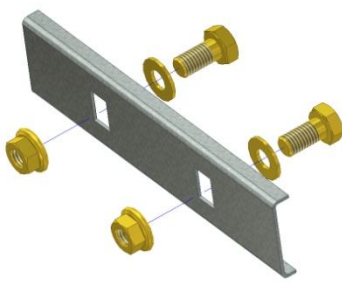
**B9262****- PLANAR SHELF TRAY  
JOINER KIT - GB**

Pack of 10 Splice Plates for Planar Shelf Trays with fasteners for reverse fold trays. Galvabond and zinc plated fasteners.

**353/01493**

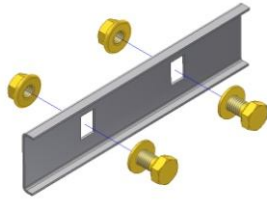
**B9558****- PLANAR SHELF TRAY  
JOINER KIT - PC**

Pack of 10 Powder Coated Splice Plates for Planar Trays with fasteners.

**B9580****~~- FRAME, SUITE ODF SUPPORT  
2.4M~~**

**OBSOLETE**

**- USE PART # B9782**

**~~353/01561~~**

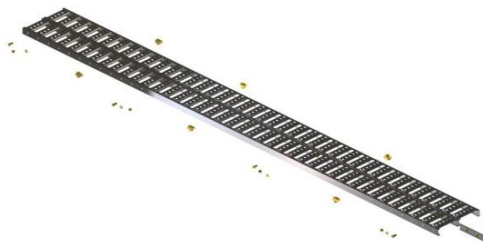
**B9100****- 300MM WIDE JOINED PLANAR  
TRAY KIT**

Two 150mm wide Planar Shelf Trays assembled. 300mm x 3000mm.lg. Powder coated finish. Splice plates and fasteners.(also ref part B9114 & B0150 PC)

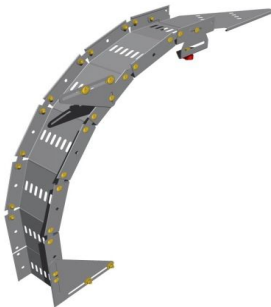
**B9181-01-LH****- ASSEMBLY, EQP SUITE OF CABLE  
LHS DROP**

Module to support 'OF' cable drop from horizontal Cable Tray on its left hand side.

All fasteners include. Supplied unassembled and cable tray requires bending on site to suit.

**353/01555**

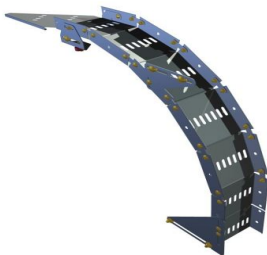
**B9181-01-RH****- ASSEMBLY, EQP SUITE OF CABLE  
RHS DROP**

Module to support 'OF' cable drop from horizontal Cable Tray on its right hand side.

All fasteners include. Supplied unassembled and cable tray requires bending on site to suit.

**353/01554**



**B9181-10**  
**- KIT, HDODF SUITE SUPPORT NGN CABLE TRAY**

Module to support two 220mm wide ducts for 'OF' Pig Tails (lower level) & 300mm. wide Cable Tray for 'OF' cable. Used in NGN Superstructure. Unassembled.

*353/01552*



**B9533-01**  
**- KIT, EQP SUITE SUPPORT NGN CABLE TRAY & FIBRE DUCTING**

Intrasuite Support module for up to 300mm wide Cable Tray ('OF' cable) & up to 300mm wide optical duct (OD). Also supports Drop Down Support modules (part B9181-01- R/H & L/H). Used in NGN Superstructure. Unassembled.

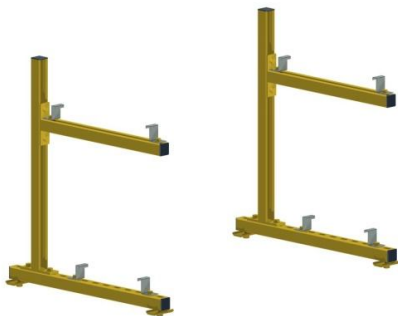

**B9181-12**  
**- KIT, INTERSUITE SUPPORT NGN CABLE TRAY**

Intersuite Support Module for Cable Trays in NGN Superstructure installations. Supplied in pairs as shown, Unassembled.

*353/01551*



**B9181-14**  
**- BRACKET, NGN EARTH COLLECTOR BAR MOUNTING**

All parts and fasteners necessary to mount Earth Collector Bar to Inter-suite Support Kit. BAR COLLECTOR NOT INCLUDED – CAN BE PURCHASED SEPARATELY. Unassembled.

*353/01553*



**B9181-15-LH**  
**- BRACKET, SUITE END LH CABLE DROP TRAY**

Bracket used for mounting adaptation of part B9181-18-LH. Used in NGN Superstructure. No fasteners.

*353/01559*

**B9181-15-RH****- BRACKET, SUITE END RH CABLE DROP TRAY**

Bracket used for mounting adaptation of part B9181-18-RH. Used in NGN Superstructure. No fasteners.

*353/01558*

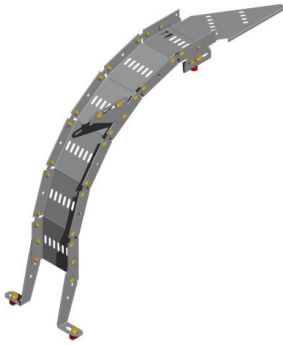
**B9181-18-LH****- ASSEMBLY, HDODF SUITE OF CABLE LHS DROP**

Module to support 'OF' cable drop above Splitting Cabinets from horizontal Cable Tray on its left hand side.

All fasteners included. Supplied unassembled and cable tray requires bending on site to suit.

*353/01557*

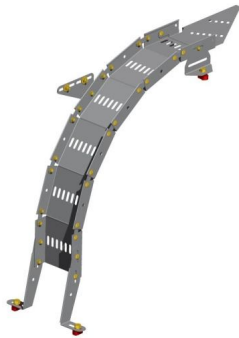
**B9181-18-RH****- ASSEMBLY, HDODF SUITE OF CABLE RHS DROP**

Module to support 'OF' cable drop above Splitting Cabinets from horizontal Cable Tray on its right hand side.

All fasteners included. Supplied unassembled and cable tray requires bending on site to suit.

*353/01556*



**MDF**  
**A DOUBLE SIDED STEEL ASSEMBLY THAT HOUSES**  
**THE CORNING CABLE SYSTEM SERIES 5000 TERMINATION BLOCKS**

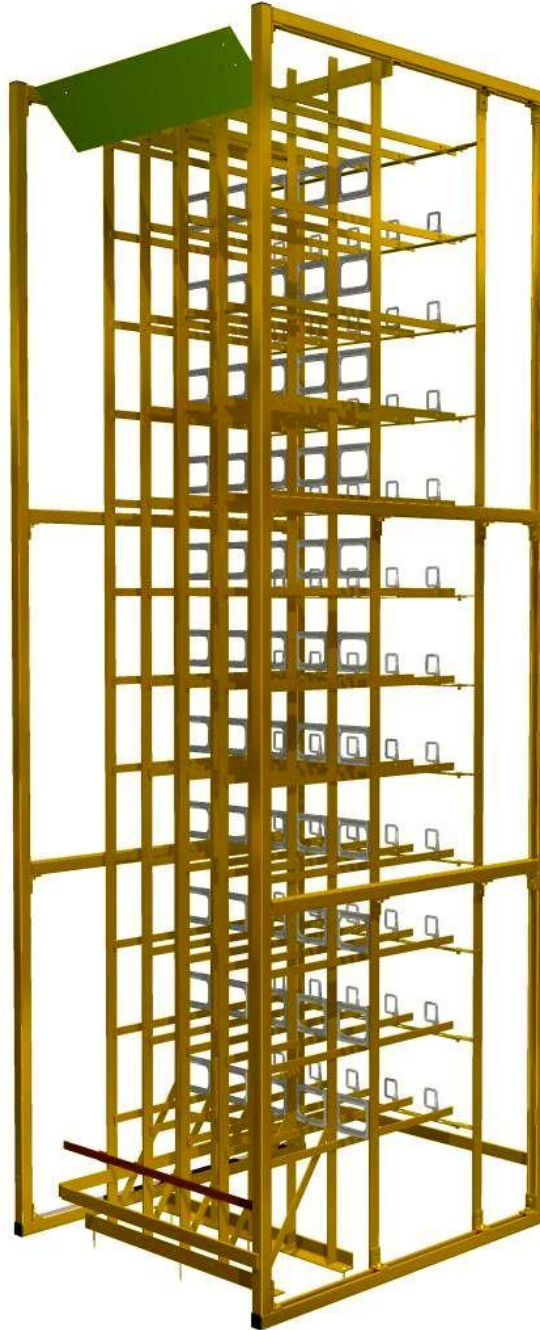

**NOTE:**

- Additional kit can be supplied to allow vertical height adjustment to align laterals with the majority of existing installations.
- Check with Telstra for approval to use.
- (site measure ups for site specific MDFs' also available)

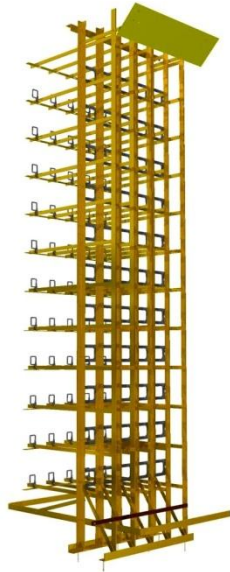
**B9400-01****- STANDARD MDF – 175x5 VERTICAL MODULE**

*Pre-manufactured 5 Vertical Support Angles with Laterals, Jumper Plates, Kick Bar and all fasteners. Can be used to extend existing structure. To start new assembly it will require Support Frames – part No. B9400-02*

*Floor footprint 1139mm. (LG) x 1300mm. (W)  
Total height – 3659mm. Support Angles horizontal pitch 175mm. Vertical Termination Blocks pitch – 282mm – up to 11 blocks.  
All necessary drawings to facilitate the assembly provided.*

**B9400-02****- STANDARD MDF SUPPORT FRAMES**

*Pre-manufactured Support Frames for Module B9400-01. Required only for initial assembly. Dummy End Frame is moved 875mm to install additional MDF modules (B9401-01) if extension is required.*

*All necessary drawings to facilitate the assembly provided.*

**B9400-04****- STANDARD MDF L/H SUPPORT FRAMES**

*Pre-manufactured Support Frames for Module B9400-01. To be used in opposite assembly than in B9400-02 Required only for initial assembly. Dummy End Frame is moved 875mm to install additional MDF modules (B9401-01) if extension is required.*

*All necessary drawings to facilitate the assembly provided.*

## JOINT COVER

### INSULATION FOR BUS BAR JOINTS

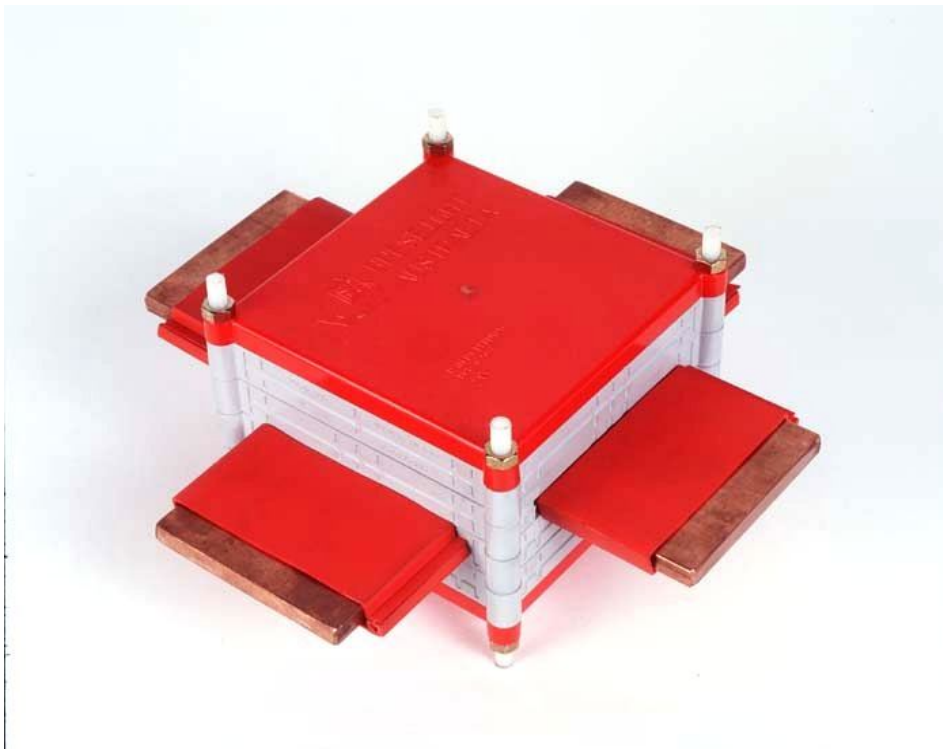

**- 18600052**

#### **- COVER SET 160 - BLUE**

Set of blue covers and fasteners for 160mm wide cross joint bus bars. Minimum order quantity of 4.



**- 18600053**

#### **- COVER SET 160 - RED**

Set of red covers and fasteners for 160mm wide cross joint bus bars. Minimum order quantity of 4.

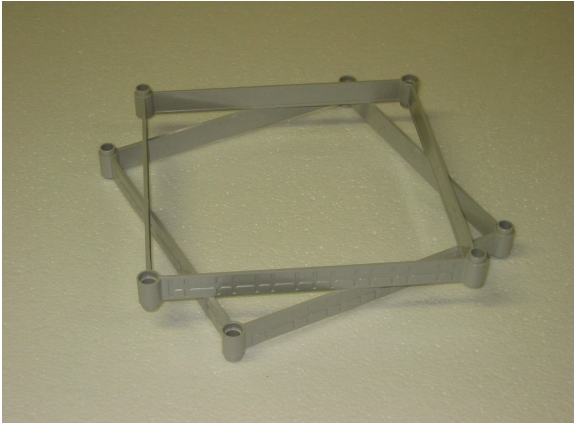

**- 18600054**

**- INFIL 160**

Set of infill's for 160mm wide cross joint bus bars. Minimum order quantity of 30.



**- 18600055**

**- COVER SET 100 - BLUE**

Set of blue covers and fasteners for 100mm wide cross joint bus bars. Minimum order quantity of 6.



**- 18600056**

**- COVER SET 100 - RED**

Set of red covers and fasteners for 100mm wide cross joint bus bars. Minimum order quantity of 6.



**- 18600057**

**- INFIL 100**

Set of infill's for 100mm wide cross joint bus bars. Minimum order quantity of 30.

